

 **UNITRA**

15

Telewizyjny odbiornik
przenośny

Neptun 150

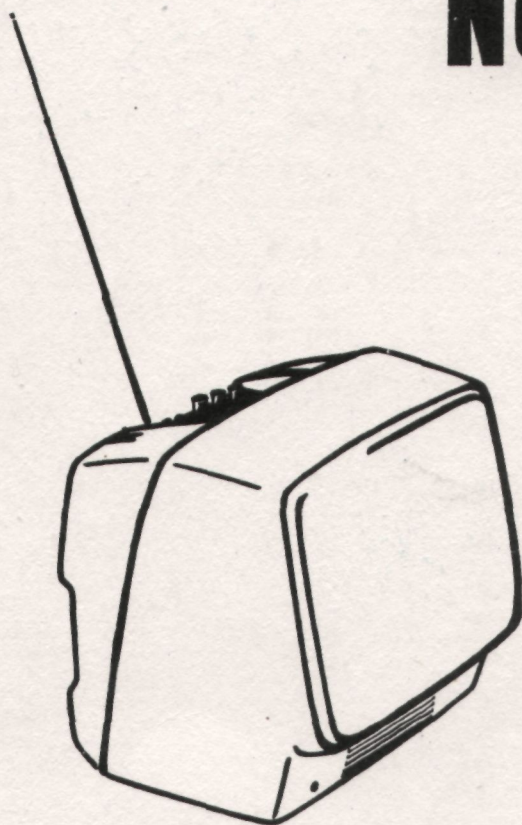

**KATALOG ZESPOŁÓW
I CZĘŚCI ZAMIENNYCH**

Niniejszy dokument stanowi katalog części zamiennych koniecznych do dokonywania napraw. Ilość części uwzględniona w rubryce 7, jest ilością na 100 szt., które powinny nadejść do hurtowni WPHW patronackiego wraz z pierwszą partią sprzętu zgodnie z pkt. 4.3.11 porozumienia zawartego pomiędzy CPHW i ZPS w dniu 6.05.1977r.

Za kompletność katalogu odpowiada producent sprzętu. W przypadku braku jakiegokolwiek elementu lub podzespołu niezbędnego do dokonywania napraw, a nie umieszczonego w katalogu producent jest zobowiązany przesłać brakujący element w ciągu 14 dni od daty zamówienia oraz odpowiednio uzupełnić katalog.

K A T A L O G

ZESPÓŁÓW I CZĘŚCI ZAMIENNYCH

d o odbiornika telewizyjnego przenośnego typu "NEPTUN 150"

DANE DOTYCZĄCE WYDAWANYCH UZUPEŁNIEŃ KATALOGU

| Numer uzupełnienia | okres wydania uzupełnienia | | Termin wyekspirów. obowiązku dostaw części wycof. z produkcji. | Oznaczenie typu wyrobu po wprowadzonych zmianach. |
|-----------------------|----------------------------|-----|--|---|
| | miesiąc | rok | | |
| | | | | |
| | | | | |
| | | | | |
| | | | | |
| | | | | |
| | | | | |

PRODUCENT: UNITRA-UNIMOR GDAŃSKIE ZAKŁADY RADIOWE ul. RZEŻNICKA 54/56 80-958 GDAŃSK 1

OKRES WYDANIA: WRZESIEŃ 1980r.

Rys.1. Demontaż obudowy odbiornika.

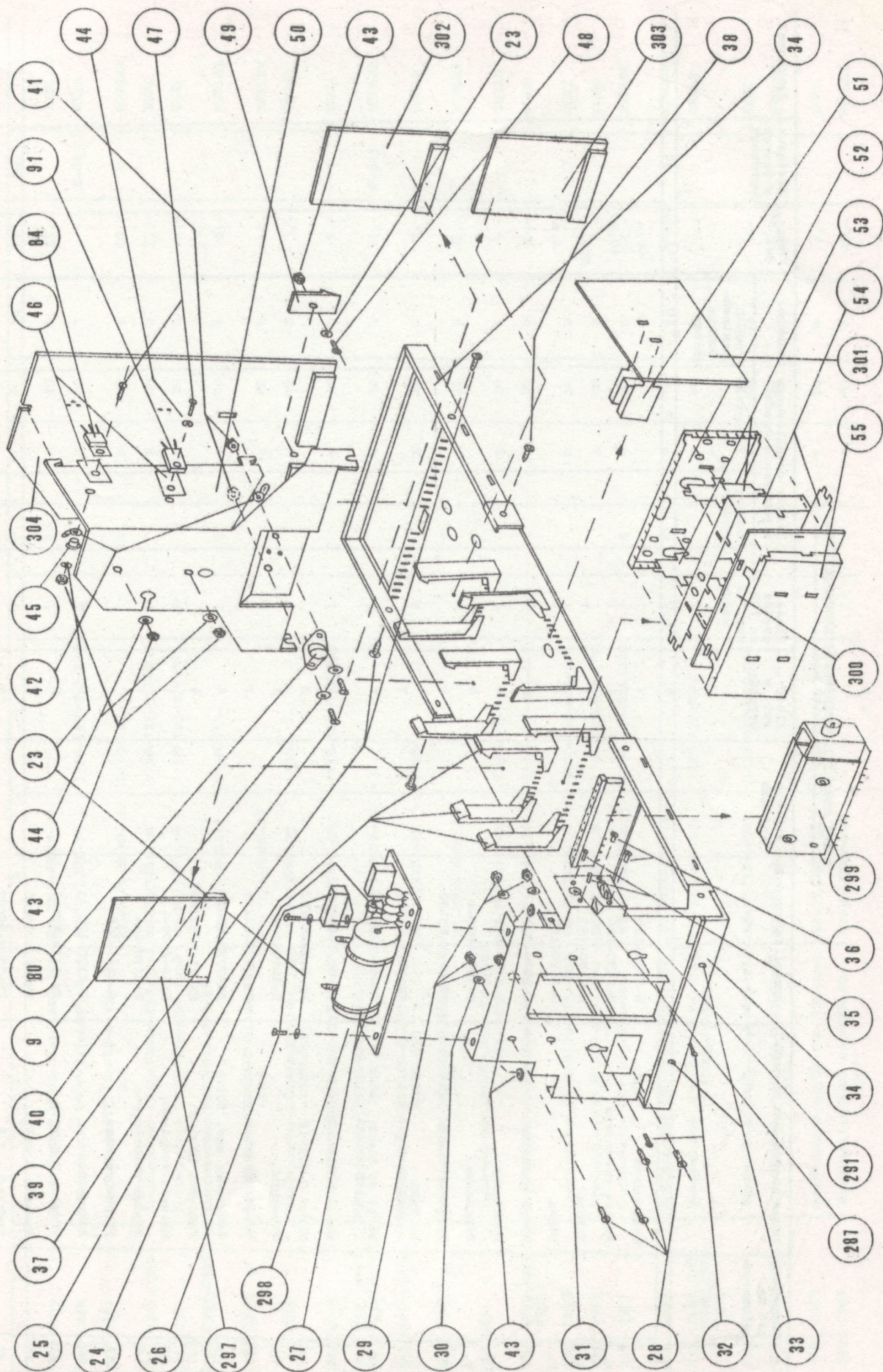

Rys.2. Demontaż chassis odbiornika.

WYKAZ DETALI I PODZESPOŁÓW MECHANICZNYCH

| 1p | Oznaczenie na schemacie | Nazwa części lub zespołu | Symbol fabryczny | Symbol indeksu | Ilość szt. w wyrobie | Ilość części na 100 szt. wyr. do I wsadu | Zasady detaliowania części i pakowania | Rodzaj opakow. | Zawartość | Sposób zamieszczania metek | Cena det. | Zastosow. w innych wyrobach | Producent |
|-----|-------------------------|----------------------------|------------------|----------------|----------------------|--|--|----------------|-----------|----------------------------|-----------|-----------------------------|-----------|
| 1. | | Maskownica | B-2170-124 | 5 | 1 | 1 | | 8 | 9 | 10 | 11 | 12 | 13 |
| 2. | | Płytki maskująca | B-2170-126 | | 1 | 1 | | | | | 40,- | | |
| 3. | | Korpus | H-2170-123 | | 1 | 1 | | | | | 10,50 | | |
| 4. | | Nóżka | C-2170-128 | | 4 | 8 | | | | | 200,- | | |
| 5. | | Klipsz głośnika | C-2240-074 | | 2 | 4 | | | | | 2,- | | |
| 6. | | Podkładka | D-2170-019 | | 8 | | | | | | 2,- | | |
| 7. | | Podkładka | D-1645-005-2 | | 4 | | | | | | | | |
| 8. | | Wkręt do blach | PN-61/M-83102 | | 4 | | | | | | | | |
| 9. | | Ok, 2x22 Podkładka 4,3 | PN-78/M-82007 | | 7 | | | | | | | | |
| 10. | | Wkręt do blach C 3,9x18 | PN-61/M-83106 | | 4 | | | | | | | | |
| 11. | | Wąż 0 z PCW 12x1 | PN-67/C-89209 | | 215mm | | | | | | | | |
| 12. | | Wkręt C 2,9x12 | PN-61/M-83106 | | 2 | | | | | | | | |
| 13. | | Wspornik | D-2210-201 | | 1 | | | | | | | | |
| 14. | | Wkręt M3x6-4,8-II | PN-74/M-82227 | | 2 | | | | | | | | |
| 15. | | Podkładka spr. 3,1 | PN-77/M-82008 | | 2 | | | | | | | | |
| 16. | | Nakrętka M3-6-I | PN-75/M-821444 | | 4 | | | | | | | | |
| 17. | | Chassis kompletne | 9150-2000-1 | | 1 | | | | | | | | |
| 18. | | Płytki dekoracyjna | B-2170-144 | | 1 | | | | | | | | |
| 19. | | Płytki regulacji | C-2240-069 | | 1 | | | | | | | | |
| 20. | | Pokrętło | D-2170-137 | | 3 | 3 | | | | | | | |
| 21. | | Wkręt C 3,5 x 12 | PN-61/M-83106 | | 2 | | | | | | | | |
| 22. | | Wkręt A 2,9x9 | PN-61/M-83106 | | 6 | | | | | | | | |
| 23. | | Podkładka 3,2 | PN-78/M-82007 | | 10 | | | | | | | | |

| 1 | 2 | 3 | 4 | 5 | 6 | 7 | 8 | 9 | 10 | 11 | 12 | 13 |
|-----|-----------------------------------|---|--------------------------|---|----|---|---|---|----|----|----|----|
| 24. | Kolpak | | D-2170-145 | | 1 | | | | | | | |
| 25. | Sprężyna kontaktowa do Bz 901 | | C-2570-016 | | 2 | | | | | | | |
| 26. | Wkręt M3x8-4,8-I | | PN-74/M-82227 | | 2 | | | | | | | |
| 27. | Obejma | | ZN-79/T-18-145 | | 2 | | | | | | | |
| 28. | Wkręt M4x10-4,8-I | | PN-74/M-82227 | | 4 | | | | | | | |
| 29. | Nakrętka M4-6-I | | PN-75/M-82144 | | 4 | | | | | | | |
| 30. | Podkładka spr. 4,1 | | PN-77/M-82008 | | 4 | | | | | | | |
| 31. | Wspornik II | | B-222D-298 | | 2 | | | | | | | |
| 32. | Wkręt M3x5-4,8-I | | PN-74/M-82227 | | 2 | | | | | | | |
| 33. | Nit 3x6-AL | | PN-70/M-82952 | | 4 | | | | | | | |
| 34. | Łałwa chassis | | C-2240-070-1 | | 1 | | | | | | | |
| 35. | Nit 2x8-AL | | PN-70/M-82952 | | 2 | | | | | | | |
| 36. | Nit rurkowy wzmocniony | | D-1530-005-1 | | 2 | | | | | | | |
| 37. | Wspornik | | C-2170-111 | | 10 | | | | | | | |
| 38. | Wkręt C 3,9x6,5 | | DIN 7971 | | 1 | | | | | | | |
| 39. | Wkręt C 3,9x9 | | PN-61/M-83106 | | 3 | | | | | | | |
| 40. | Wkręt M4x8-4,8-II | | PN-74/M-82227 | | 2 | | | | | | | |
| 41. | Nakrętka M4-6-II | | PN-75/M-82144 | | 2 | | | | | | | |
| 42. | Końcówka lutownicza KJ-2-10-Ag | | ZN-70/MFN-14/ T15-086 | | 2 | | | | | | | |
| 43. | Nakrętka M 3-6-II | | PN-75/M-82144 | | 4 | | | | | | | |
| 44. | Podkładka | | D-1641-005-1 | | 3 | | | | | | | |
| 45. | Tulejka | | D-1830-128 | | 1 | | | | | | | |
| 46. | Podkładka | | D-2460-308 | | 2 | | | | | | | |
| 47. | Wkręt M3x8-4,8-II | | PN-74/M-82227 | | 1 | | | | | | | |
| 48. | Wkręt M3x10-4,8-II | | PN-74/M-82227 | | 2 | | | | | | | |

WYKAZ ELEMENTÓW ELEKTRYCZNYCH

| Lp | Oznaczenie na schemacie | Nazwa części lub zespołu | Symbol fabryczny | Symbol indeksu | Ilość szt. w wy- robie | Ilość części na 100 szt. szt. | Zasady detalicznego oznaczania i pakowania | | Cena det. /zł/ | Zastosowanie w innych wyrobach | Producent |
|----|-------------------------------|--------------------------|---------------------|-------------------|---------------------------------|---|---|--|----------------------|--------------------------------------|-----------|
| | | | | | | | Rodzaj opaków. | Zawartość Sposób zamie- szanie- nia metek | | | |
| 71 | U 11 | Układ scalony UL 1550L | TWT-73/Cemi/B-07 | 1156-313-101-005 | 1 | | | 10 | 50,00 | N-625 | CEMI |
| 72 | U101 | Układ scalony TDA 440 | | 1156-312-002-002 | 1 | 2 | | | | N-625 | TEK |
| 73 | U201 | Układ scalony UL 1244N | TWT-78/Cemi/B-106 | 1156-312 | 1 | 2 | | | 102,- | | CEMI |
| 74 | U202 | Układ scalony UL 149R | TWT-75/Cemi/B-37 | 1156-314-118-006 | 1 | 3 | | | 80,- | | CEMI |
| 75 | U251 | Układ scalony UL 1262N | TWT-76/Cemi/B-82 | 1156-3121-109-006 | 1 | 2 | | | 208,- | N-625 | CEMI |
| 76 | U301 | Układ scalony TDA 1170 | | | 1 | 2 | | | 170,- | N-625 | ATES |
| 77 | T101 | Transystor BC238B | WT-76/Cemi/A-35 | 1156-211-315-032 | 1 | | | | 20,- | | CEMI |
| 78 | T102 | Transystor BF 197 | WT-76/Cemi/A-06 | 1156-213-317-009 | 1 | | | | 23,- | N-427 | CEMI |
| 79 | T351 | Transystor BF-457 | WT-75/Cemi/A-43 | 1156-223-301-000 | 1 | 2 | | | 36,- | | CEMI |
| 80 | T951 | Transystor 2N 3055 | | 1156- | 1 | 2 | | | | | TUNGSRAM |
| 81 | T952 | Transystor BC 313/16 | WT-76/Cemi/A-14 | 1156-221-401-033 | 1 | 2 | | 10 | 36,- | | CEMI |
| 82 | T953 | Transystor BC 238-B | WT-76/Cemi/A-35 | 1156-211-315-032 | 1 | | | | 20,- | | CEMI |
| 83 | T954 | Transystor BC 211/16 | WT-76/Cemi/A-01 | 1156-221-402-034 | 1 | 2 | | | 36,- | | CEMI |
| 84 | T955 | Transystor BU 407D | | 1156-211 | 1 | 4 | | | | | ATES |
| 85 | T956 | Transystor BC 238-A | WT/Cemi/A-14 | 1156-211-302-016 | 1 | | | | 20,- | | CEMI |
| 86 | D11, D12, D13 D101, D102 | Dioda BAP 795 | TWT-72/Cemi/A-54 | 1156-131-307-004 | 5 | | | 10 | 10,- | | CEMI |
| 87 | D302 | Diody BAP-401-50 | TWT-72/Cemi/A-57 | 1156-112-203-009 | 1 | 2 | | | 10,- | | CEMI |
| 88 | D351 | Diody BAP 20 | WT-76/Cemi/B12/A-6 | 1156-132-504-002 | 1 | | | 10 | 20,- | N-625 | CEMI |
| 89 | D951 | Diody BAP 68J6V8 | TWT-75/Cemi/B-12/A2 | 1156-142 | 1 | 1 | | 10 | 30,- | | CEMI |
| 90 | D952 | Diody BAP 17 | WT-76/Cemi/B12/A-6 | 1156-132-501-000 | 1 | | | | 8,- | N-623 | ITE TORON |
| 91 | D953 | Diody BAP 71-350R | Imp. Hollandia | | 1 | 4 | | | | | PHILIPS |
| 92 | D955, D956, D957 | Diody BA 159 | TWT-76/Cemi/A-67 | 1156-112-207-002 | 3 | 3 | | 10 | | | CEMI |
| 93 | D 901 | Diody KY50/80 | Kat. TESLA | | 1 | 2 | | | | | TESLA |

| 1 | 2 | 3 | 4 | 5 | 6 | 7 | 8 | 9 | 10 | 11 | 12 | 13 |
|-----|---|-----------------------------|-----------------|------------------|---|---|---|----|----|--------|-------|----------|
| 94 | D902 | Dloda KY 940/80 | Kat. TESLA | 1155-315-300-112 | 1 | 2 | | | | | | TESLA |
| 95 | D954 | Prostownik TV13-03 | H320-005-034-76 | | 1 | 2 | | | | | | Bulgaria |
| 96 | | Kineskop A31-310W 12" | VT-73/L-12/18 | | 1 | 1 | | | | 1100,- | | ZELOS |
| 97 | R12 | Rezystor OWZ-0125-2,7k-5% | VT-77/L-7/072 | | 1 | | z | 10 | b | 2,- | | TELPD |
| 98 | R101 | Rezystor OWZ-0125-22-5% | VT-77/L-7/072 | | 1 | | z | 10 | b | 2,- | | TELPD |
| 99 | R102 | Rezystor OWZ-0125-120-5% | VT-77/L-7/072 | | 1 | | z | 10 | b | 2,- | | TELPD |
| 100 | R 104 | Rezystor OWZ-0125-6,8k-5% | VT-77/L-7/072 | | 1 | | z | 10 | b | 2,- | N-427 | TELPD |
| 101 | R106, R206 | Rezystor OWZ-0125-47k-5% | VT-77/L-7/072 | | 2 | | z | 10 | b | 2,- | | TELPD |
| 102 | R107 | Rezystor MLT-025-180-5-435 | EN-78/3281-36 | | 1 | | z | 10 | b | 5,- | | TELPD |
| 103 | R108 | Rezystor OWZ-0125-360-5% | VT-77/L-7/072 | | 1 | | z | 10 | b | 2,- | | TELPD |
| 104 | R 110 | Rezystor OWZ-0125-3,3k-5% | VT-77/L-7/072 | | 1 | | z | 10 | b | 2,- | | TELPD |
| 105 | R111, R112, R118, R126, R211, R260, R316 | Rezystor OWZ-0125-1k-5% | VT-77/L-7/072 | | 7 | | z | 10 | b | 2,- | | TELPD |
| 106 | R113, R114, R125 | Rezystor OWZ-0125-330-5% | VT-77/L-7/072 | | 3 | | z | 10 | b | 2,- | | TELPD |
| 107 | R115, R119, R120, R123 | Rezystor OWZ-0125-15k-5% | VT-77/L-7/072 | | 4 | | z | 10 | b | 2,- | | TELPD |
| 108 | R116, R203 | Rezystor OWZ-0125-5,1k-5% | VT-77/L-7/072 | | 2 | | z | 10 | b | 2,- | | TELPD |
| 109 | R117, R121, R122 | Rezystor OWZ-0125-100-5% | VT-77/L-7/072 | | 3 | | z | 10 | b | 2,- | | TELPD |
| 110 | R124 | Rezystor MLT-025-1,2k-5-435 | EN-78/3281-36 | | 1 | | z | 10 | b | 5,- | | TELPD |
| 111 | R201 | Rezystor OWZ-0125-470-+ | VT-77/L-7/072 | | 1 | | z | 10 | b | 2,- | | TELPD |
| 112 | R202 | Rezystor OWZ-0125-820-5% | VT-77/L-7/072 | | 1 | | z | 10 | b | 2,- | | TELPD |
| 113 | R204 | Rezystor MLT-025-120-5-435 | EN-78/3281-36 | | 1 | | z | 10 | b | 5,- | | TELPD |
| 114 | R205, R261 | Rezystor OWZ-0125-33k-5% | VT-77/L-7/072 | | 2 | | z | 10 | b | 2,- | | TELPD |
| 115 | R314, R315 | Rezystor OWZ-0125-10k-5% | VT-77/L-7/072 | | 2 | | z | 10 | b | 2,- | | TELPD |
| 116 | R212 | Rezystor MLT-025-100k-5-435 | EN-78/3281-36 | | 1 | | z | 10 | b | 5,- | | TELPD |
| 117 | R213, R310 | Rezystor RVMC-0414-0-1R-5% | VT-78/L-7/215 | | 2 | 4 | z | 10 | b | 7,- | | TELPD |
| 118 | R251 | Rezystor MLT-025-1,2k-5-435 | EN-78/3281-36 | | 1 | 2 | z | 10 | b | 5,- | | TELPD |
| 119 | R252 | Rezystor OWZ-0125-1,8k-5% | VT-77/L-7/072 | | 1 | | z | 10 | b | 2,- | | TELPD |

| 1 | 2 | 3 | 4 | 5 | 6 | 7 | 8 | 9 | 10 | 11 | 12 | 13 |
|-----|------------|------------------------------|-----------------------|---|---|---|---|----|----|-----|-------|--------|
| 120 | R253, R303 | Rezystor OWZ-0125-150k-5% | WT-77/L-7/072 | | 2 | | z | 10 | b | 2,- | | TELPOD |
| 121 | R254 | Rezystor RMC-025-10,5-1% | ZN-72/MFN-14/L-18/001 | | 1 | 2 | z | 10 | b | 7,- | | OMIG |
| 122 | R255 | Rezystor OWZ-0125-100k-5% | WT-77/L-7/072 | | 1 | | z | 10 | b | 2,- | | TELPOD |
| 123 | R257 | Rezystor OWZ-0125-680-5% | WT-77/L-7/072 | | 1 | | z | 10 | b | 2,- | | TELPOD |
| 124 | R258 | Rezystor MLT-025-47-5%-435 | EN-78/3281-36 | | 1 | | z | 10 | b | 3,- | | TELPOD |
| 125 | R301 | Rezystor MLT-05-10-10%-435 | EN-78/3281-36 | | 1 | | z | 10 | b | 3,- | | TELPOD |
| 126 | R304, 313 | Rezystor OWZ-0125-220k-5% | WT-77/L-7/072 | | 2 | | z | 10 | b | 2,- | | TELPOD |
| 127 | R306 | Rezystor OWZ-0125-300k-5% | WT-77/L-7/072 | | 1 | | z | 10 | b | 2,- | | TELPOD |
| 128 | R307 | Rezystor OWZ-0125-22k-5% | WT-77/L-7/072 | | 1 | | z | 10 | b | 2,- | | TELPOD |
| 129 | R309 | Rezystor OWZ-0125-68k-5% | WT-77/L-7/072 | | 1 | | z | 10 | b | 2,- | | TELPOD |
| 130 | R311 | Rezystor OWZ-0125-8,2k-5% | WT-77/L-7/072 | | 1 | | z | 10 | b | 2,- | | TELPOD |
| 131 | R312 | RMC-0414-043R-5% Rezystor | WT-78/L-7/215 | | 1 | | z | 10 | b | 7,- | | TELPOD |
| 132 | R351 | Rezystor OWZ-0125-150-10% | WT-77/L-7/072 | | 1 | | z | 10 | b | 1,- | | TELPOD |
| 133 | R352 | Rezystor MLT-05-180-5%-435 | EN-78/3281-36 | | 1 | | z | 10 | b | 5,- | | TELPOD |
| 134 | R353 | Rezystor OWZ-0125-68-5% | WT-77/L-7/072 | | 1 | | z | 10 | b | 2,- | | TELPOD |
| 135 | R354 | Rezystor MLT-2-4,7k-5%-435 | EN-78/3281-36 | | 1 | | z | 10 | b | 5,- | N-427 | TELPOD |
| 136 | R355 | Rezystor OWZ-025-470k-10% | WT-77/L-7/072 | | 1 | | z | 10 | b | 1,- | | TELPOD |
| 137 | R356 | Rezystor OWZ-05-2,2k-10% | WT-77/L-7/072 | | 1 | | z | 10 | b | 1,- | | TELPOD |
| 138 | R357 | Rezystor MLT-05-330k-10%-435 | EN-78/3281-36 | | 1 | | z | 10 | b | 3,- | | TELPOD |
| 139 | R951 | Rezystor OWZ-1-68-10% | WT-77/L-7/072 | | 1 | | z | 10 | b | 1,- | | TELPOD |
| 140 | R952 | Rezystor OWZ-025-160k-5% | WT-77/L-7/072 | | 1 | | z | 10 | b | 1,- | | TELPOD |
| 141 | R953 | Rezystor OWZ-025-220-5% | WT-77/L-7/072 | | 1 | | z | 10 | b | 2,- | | TELPOD |
| 142 | R954 | Rezystor OWZ-025-2,2k-5% | WT-77/L-7/072 | | 1 | | z | 10 | b | 2,- | | TELPOD |
| 143 | R955, R957 | Rezystor OWZ-025-1k-5% | WT-77/L-7/072 | | 2 | | z | 10 | b | 2,- | N-625 | TELPOD |
| 144 | R958 | Rezystor OWZ-1-47-5% | WT-77/L-7/072 | | 1 | | z | 10 | b | 2,- | | TELPOD |
| 145 | R959 | Rezystor OWZ-025-470-5% | WT-77/L-7/072 | | 1 | | z | 10 | b | 2,- | | TELPOD |
| 146 | R960 | Rezystor 025-10k-5% | WT-77/L-7/072 | | 1 | | z | 10 | b | 2,- | | TELPOD |
| 147 | R961 | Rezystor MLT-1-330-5%-435 | EN-78/3281-36 | | 1 | 1 | z | 10 | b | 5,- | | TELPOD |
| 148 | R962 | Rezystor OWZ-05-68k-5% | WT-77/L-7/072 | | 1 | | z | 10 | b | 2,- | | TELPOD |
| 149 | R210 | Rezystor OWZ-0125-39-5% | WT-77/L-7/072 | | 1 | | z | 10 | b | 2,- | | TELPOD |
| 150 | R963 | Rezystor OWZ-025-47k-5% | WT-77/L-7/072 | | 1 | | z | 10 | b | 2,- | N-625 | TELPOD |

| | | | | | | | | | |
|-----|----------------------------------|--|---------------|---|---|---|----|------|--------|
| 151 | R964 | Rezystor OWZ-025-33k-5% | WT-77/L-7/072 | 1 | 2 | 2 | 10 | 2,- | TELPOD |
| 152 | R965 | Rezystor OWZ-025-100k-5% | WT-77/L-7/072 | 1 | | | 10 | 2,- | TELPOD |
| 153 | R966 | Rezystor OWZ-025-15k-5% | WT-77/L-7/072 | 1 | | | 10 | 2,- | TELPOD |
| 154 | R967 | Rezystor OWZ-025-560-5% | WT-77/L-7/072 | 1 | | | 10 | 2,- | TELPOD |
| 155 | R968 | Rezystor OWZ-025-4,7k-5% | WT-77/L-7/072 | 1 | | | 10 | 2,- | TELPOD |
| 156 | R969, R970 | Rezystor OWZ-05-22k-5% | WT-77/L-7/072 | 2 | | | 10 | 2,- | TELPOD |
| 157 | R971 | Rezystor OWZ-05-15-5% | WT-77/L-7/072 | 1 | | | 10 | 2,- | TELPOD |
| 158 | R972 | Rezystor MLT-1-47-5%-435 | EN-78/3281-36 | 1 | 2 | | 10 | 5,- | TELPOD |
| 159 | R973 | Rezystor OWZ-025-3,3k-5% | WT-77/L-7/072 | 1 | | | 10 | 2,- | TELPOD |
| 160 | R974 | Rezystor OWZ-05-100-5% | WT-77/L-7/072 | 1 | | | 10 | 2,- | TELPOD |
| 161 | R975 | Rezystor MLT-2-12k-5%-435 | EN-78/3281-36 | 1 | 1 | | 10 | 5,- | TELPOD |
| 162 | R977 | Rezystor OWZ-025-1M-10% | WT-77/L-7/072 | 1 | | | 10 | 2,- | TELPOD |
| 163 | R978 | Rezystor OWZ-05-10-10% | WT-77/L-7/072 | 1 | | | 10 | 2,- | TELPOD |
| 164 | R979 | Rezystor OWZ-025-330-5% | WT-77/L-7/072 | 1 | | | 10 | 2,- | TELPOD |
| 165 | R980 | Rezystor MLT-05-1M-10%-435 | EN-78/5281-36 | 1 | | | 10 | 3,- | TELPOD |
| 166 | R981 | Potencjometr PR-185-1k-A-15P5 | WT-74/L-7/152 | 1 | 2 | | | 14,- | TELPOD |
| 167 | R982 | Potencj. PR-185-1k-A-15P5 | WT-74/L-7/152 | 1 | 2 | | | 14,- | TELPOD |
| 168 | R984 | Potencj. PR-185-4,7k-A-15P5 | WT-74/L-7/152 | 1 | 2 | | | 14,- | TELPOD |
| 169 | R985 | Potencj. TYP-114-22k | WT-73/L-7/143 | 1 | | | 10 | 5,- | TELPOD |
| 170 | R41 | Potencj. TYP-102-10k | WT-77/L-7/177 | 1 | 1 | | 10 | 8,- | TELPOD |
| 171 | R105, R109 | Potencj. TYP-101-4,7k | WT-77/L-7/177 | 2 | 2 | | 10 | 8,- | TELPOD |
| 172 | R256, R259 | Potencj. TYP-115-10k | WT-73/L-7/143 | 2 | 2 | | 10 | 5,- | TELPOD |
| 173 | R308 | Potencj. TYP-114-47k | WT-73/L-7/143 | 1 | 2 | | 10 | 5,- | TELPOD |
| 174 | R302, R305 | Potencj. TYP-114-100k | WT-73/L-7/143 | 2 | 2 | | 10 | 5,- | TELPOD |
| 175 | R956 | Potencj. TYP-114-1k | WT-73/L-7/143 | 1 | 2 | | 10 | 5,- | TELPOD |
| 176 | R976 | Potencj. TYP-202-2,2M-A | WT-77/L-7/222 | 1 | 2 | | 10 | 5,- | TELPOD |
| 177 | C851 | Kondensator KCP-1B-N150-8r 56-5%-50V-658 | EN-78/3281-30 | 1 | | | 20 | 6,- | CERAD |
| 178 | C14, C902, C903, 904, C905 | Kondensator KPP-2E-10-47000/ 20-50/250V-655 | EN-78/3281-25 | 5 | | | 20 | 4,- | CERAD |

| 1 | 2 | 3 | 4 | 5 | 6 | 7 | 8 | 9 | 10 | 11 | 12 | 13 |
|-----|---|---|-----------------|------------------|---|----------|---|----|----|------|-------|--------|
| 179 | C15, C203 C210 | Kondensator MKSE-20-022u-20% -100V | WT-77/1-MKSE-20 | | 3 | | z | 20 | b | 25,- | N-625 | MIFLEX |
| 180 | C101 | Kondensator KCPf-1B-N150-10x10- 100-5-25-25/085/10 | BN-78/3281-30 | 1158-136-374-487 | 1 | | z | 20 | b | 8,- | | CERAD |
| 181 | C121 | Kondensator KCP-1B-N150-6-22-5- -160-25/085/10 | BN-78/3181-35 | 1158- | 1 | | z | 20 | b | 4,- | | CERAD |
| 182 | C103, 108 | Kondensator KCPf-1BN750-8x8-180- -5-25-25/085/19 | BN-78/3281-30 | 1158-136-634-562 | 2 | | z | 20 | b | 6,- | | CERAD |
| 183 | C102, C104 C106 | Kondensator KCP-1B-N47-5x5-27-5- -25-25/085/10 | BN-78/3281-35 | 1158-136-194-244 | 3 | | z | 20 | b | 8,- | | CERAD |
| 184 | C105, C128 C127 | Kondensator KCPf-1B-N47-5x5-27-5- -25-25/085/10 | BN-78/3281-35 | 1158-135-194-244 | 3 | | z | 20 | b | 3,- | | CERAD |
| 185 | C106 | Kondensator KCPf-1B-N47-5x5-27-5- -25-25/085/10 | BN-78/3281-30 | 1158-136-194-224 | 1 | poz. 113 | z | 20 | b | 8,- | | CERAD |
| 186 | C107, C127 | Kondensator KCPf-1B-N150-6-15- -5-250-25/085/10 | BN-78/3281-35 | 1158- | 2 | | z | 20 | b | 4,- | | CERAD |
| 187 | C109, C131 | Kondensator KCPf-1B-N150-6x6- -47-5-25-25/085/10 | BN-78/3281-30 | 1158-136-344-085 | 2 | | z | 20 | b | 8,- | | CERAD |
| 188 | C110 | Kondensator KFPf-2E-10x10-10000- -20x50/-25-25/085/10 | BN-78/3281-26 | 1158- | 1 | | z | 20 | b | 4,- | | CERAD |
| 189 | C111 | Kondensator KCPf-1B-N150-5x5- 39-5-25-25/085/10 | BN-78/3281-30 | 1158-136-314-727 | 1 | | z | 20 | b | 8,- | | CERAD |
| 190 | C112, C206 | Kondensator 04/U-10u-16V typ2 | BN-77/3281-38 | 1158-127-051-609 | 2 | | z | 20 | b | 4,- | | ELWA |
| 191 | C113, C116, C125, C126, C130, C133, C139, C969 | Kondensator KFP-2E-6x6-47000/ 50-20/25-25/085/10 | BN-78/3281-26 | 1158- | 8 | | z | 20 | b | 3,- | | CERAD |
| 192 | C114 | Kondensator KFPf-2E-5x5-2200/ 50-20/25-25/085/10 | BN-78/3281-26 | 1158- | 1 | | z | 20 | b | 3,- | | CERAD |
| 193 | C119, C120 C254 | Kondensator 04/U-47u-16V typ2 | BN-77/3281-30 | 1158-128-051-680 | 3 | | z | 20 | b | 4,- | | ELWA |
| 194 | C122 | Kondensator KCPf-1B-N150-6x6- 68-5-25-400-25/085/ 10 | BN-78/3281-30 | 1158- | 1 | | z | 20 | b | 8,- | | CERAD |
| 195 | C123, C132 | Kondensator KFP-2E-5-1000-150- -20x50/-250-25/085/ 10 | BN-78/3281-25 | 1158- | 2 | | z | 20 | b | 2,- | | CERAD |
| 196 | C124 | Kondensator KCP-1B-N150-5-6-8- 05-400-25/085/10 | BN-78/3281-35 | 1158- | 1 | | z | 20 | b | 3,- | | CERAD |

| 1 | 2 | 3 | 4 | 5 | 6 | 7 | 8 | 9 | 10 | 11 | 12 | 13 |
|-----|---|--|-----------------|------------------|---|---|---|----|----|------|----|--------|
| 197 | C971, C135, C253, C255, C261, C303, C970 | Kondensator MKSE-20-01u-20-100V | WT-77/1-MKSE-20 | | 7 | | z | 20 | b | 11,- | | MIFLEX |
| 198 | C136 | Kondensator MKSE-20-1u-20-100V | WT-77/1-MKSE-20 | | 1 | | z | 20 | b | 25,- | | MIFLEX |
| 199 | C137 | Kondensator KCP-1B-N150-5-5,6- 05-400-25/085/10 | EN-78/3281-35 | 1158- | 1 | | z | 20 | b | 3,- | | CERAD |
| 200 | C201, C202 C208 | Kondensator KFPF-2F-10x10-22000 -25V/80-20/668 | EN-78/3281-26 | 1158-136-991-090 | 3 | | z | 20 | b | 3,- | | CERAD |
| 201 | C204 | Kondensator MKSE-20,0,047u-10% 250V | WT-77/1-MKSE-20 | 1158- | 1 | | z | 20 | b | 8,- | | MIFLEX |
| 202 | C205 | Kondensator KSF-022-1u-100V-5% -462 | WT-71/1-KSF-022 | | 1 | | z | 20 | b | 16,- | | MIFLEX |
| 203 | C207, C214 C215, C218 | Kondensator 04/U-100u-16V-typ2 | EN-77/3281-38 | 1158-127-031-726 | 4 | | z | 20 | b | 4,- | | ELWA |
| 204 | C209 | Kondensator KSF-0-01-470-5%- 63V-666 | WT-72/1-KSF-0 | | 1 | | z | 20 | b | 4,- | | MIFLEX |
| 205 | C211 | Kondensator KSF-0,01-1,8-5%- 63V-666 | WT-72/1-KSF-0 | | 1 | | z | 20 | b | 4,- | | MIFLEX |
| 206 | C213 | Kondensator KFPF-2F-12x12-47000 -25-/+80-20/-668 | EN-78/3281-26 | 1158-136-994-563 | 1 | | z | 20 | b | 6,- | | CERAD |
| 207 | C216 | Kondensator KSF-0,01-160-5%- 160V-666 | WT-72/1-KSF-0 | | 1 | | z | 20 | b | 4,- | | MIFLEX |
| 208 | C217 | Kondensator KSF-0-01-160-5% 63V-666 | WT-72/1-KSF-0 | | 1 | | z | 20 | b | 5,- | | MIFLEX |
| 209 | C220, C222 C258 | Kondensator 04/U-470u-16V typ2 | EN-77/3281-38 | 1158-127-037-795 | 3 | | z | 20 | b | 9,- | | MIFLEX |
| 210 | C221 | Kondensator MKSE-20-0,1u-10%- -100V | WT-77/1-MKSE-20 | | 1 | | z | 20 | b | 11,- | | MIFLEX |
| 211 | C251 | Kondensator MKSE-20-0,15u-20%- -100V | WT-77/1-MKSE-20 | | 1 | | z | 20 | b | 11,- | | MIFLEX |
| 212 | C252 | Kondensator MKSE-20-0,01u-20%- -400V | WT-77/1-MKSE-20 | | 1 | | z | 20 | b | 11,- | | MIFLEX |
| 213 | C117 | Kondensator 04/U-10u-63V | EN-77/3281-38 | | 1 | | z | 20 | b | | | ELWA |
| 214 | C118 | Kondensator KOPF-1B-N-750-8x8-150 -5-25-25/085/10 | EN-78/3181-30 | 1158-136-634-089 | 1 | | z | 20 | b | 6,- | | CERAD |
| 215 | C256 | Kondensator KSF-022-10u-2%-63V | WT-71/1-KSF-022 | 1158-124-348-145 | 1 | | z | 20 | b | 16,- | | MIFLEX |
| 216 | C257 | Kondensator KFP-2E-5-1000/-20 +50/ | EN-78/3281-25 | 1158-136 | 1 | | z | 20 | b | 2,- | | CERAD |

| 1 | 2 | 3 | 4 | 5 | 6 | 7 | 8 | 9 | 10 | 11 | 12 | 13 |
|-----|----------------------------------|--|------------------|------------------|---|---|---|----|----|-------|-------|--------|
| 217 | C259 | Kondensator MKSE-20-1u-20%-100V | VT-77/1-MKSE-20 | 1158-127-053-728 | 1 | 2 | z | 20 | b | 25,- | | MIFLEX |
| 218 | C260 | Kondensator 04/U-2, 2u-40V-typ2 | EN-77/3281-38 | | 1 | | z | 20 | b | 4,- | N-625 | ELWA |
| 219 | C301 | Kondensator MKSE-012-0, 15u-5% -100V | VT-68/1-MKSE-012 | 1158-124- | 1 | 1 | z | 20 | b | 23,- | | MIFLEX |
| 220 | C302, C310 | Kondensator 04/u-1000u-25V-typ2 | EN-77/3281-38 | 1158-127-052-905 | 2 | | z | 20 | b | 33,- | | ELWA |
| 221 | C304 | Kondensator 04/U-100u-25V typ2 | EN-77/3281-38 | 1158-127-052-844 | 1 | | z | 20 | b | 8,- | | ELWA |
| 222 | C305, C306 | Kondensator MKSE-012-0-1-5% -100V | VT-68/1-MKSE12 | 1158-124- | 2 | 2 | z | 20 | b | 9,- | | MIFLEX |
| 223 | C307 | Kondensator MKSE-20-0, 1u-10% -250V | VT-77/1-MKSE-20 | | 1 | | z | 20 | b | 8,- | | MIFLEX |
| 224 | C308 | Kondensator KCP-1B-N750-6-33-5% -160V-658 | EN-78/3281-35 | 1158- | 1 | | z | 20 | b | 3,- | | CERAD |
| 225 | C309 | Kondensator 04/U-22u-25V-typ2 | EN-77/3281-38 | 1158-127-052-770 | 1 | | z | 20 | b | 8,- | | ELWA |
| 226 | C311, C951 C956, C972 | Kondensator MKSE-20-0, 22u-10% -100V | VT-77/1-MKSE-20 | | 4 | | z | 20 | b | 11,- | N-625 | MIFLEX |
| 227 | C351, C352 | Kondensator KFP-2B-6-680-10% -160V-655 | EN-78/3281-25 | 1158- | 2 | | z | 20 | b | 3,- | | CERAD |
| 228 | C353 | Kondensator MKSE-20-0, 68u-20% -100V | VT-77/1-MKSE-20 | | 1 | | z | 20 | b | 25,- | | MIFLEX |
| 229 | C355 | Kondensator KFP-2E-12-10000/50 -20/160V-655 | EN-78/3281-25 | 1158-135 | 1 | | z | 20 | b | 4,- | | CERAD |
| 230 | C952, C954 C959 | Kondensator 04/U-220u-16V-typ2 | EN-77/3281-38 | 1158-127-051-767 | 3 | | z | 20 | b | 4,- | | ELWA |
| 231 | C953 | Kondensator 02/E-4, 7u-25V-typ2 | EN-77/3281-38 | 1158-127-022-690 | 1 | | z | 20 | b | 3,- | | ELWA |
| 232 | C955 | Kondensator 04/U-10u-25V-typ2 | EN-77/3281-38 | 1158-127-052-730 | 1 | | z | 20 | b | 3,- | | ELWA |
| 233 | C957 | Kondensator KSP-013-27u-10% -630V | VT-77/1-KSP-013 | 1158-124-720-020 | 1 | 2 | z | 20 | b | 12,- | | MIFLEX |
| 234 | C958 | Kondensator KFP-10-2u-5%-250V | VT-77/1-KFP-10 | | 1 | 2 | z | 10 | b | 21,50 | | MIFLEX |
| 235 | C960, C907 C908, C909 C910 | Kondensator KFP-2E-8-470/-20+50/ /-500Vp-25/085 | VT-78/1-5/103 | 1158-135-006 | 5 | | z | 20 | b | 3,- | | CERAD |
| 236 | C961 | Kondensator 04/U-220u-40V-typ2 | EN-77/3281-38 | 1158-127-053-804 | 1 | | z | 20 | b | 9,- | | ELWA |
| 237 | C962, C901 | Kondensator KMP-10-0, 22u-20% -400V | VT-77/1-KMP-10 | | 2 | 2 | z | 20 | b | 21,50 | | MIFLEX |
| 238 | C963 | Kondensator 04/U-100u-40V-typ2 | EN-77/3281-38 | 1158-127-053-797 | 1 | | z | 20 | b | 9,- | | ELWA |
| 239 | C964 | Kondensator KFP-010-47u-20- -630V | VT-76-KFP-010 | | 1 | | z | 20 | b | 25,- | | MIFLEX |

| 1 | 2 | 3 | 4 | 5 | 6 | 7 | 8 | 9 | 10 | 11 | 12 | 13 |
|-----|--------|--|----------------------------------|------------------|---|----|---|----|----|-------|-------|-------------------|
| 240 | C966 | Kondensator 04/U-20u-350V-typ2 | EN-77/3281-38 | 1158-127-056-349 | 1 | | | 20 | b | 8,- | | ELWA |
| 241 | C968 | Kondensator MKSE-20-0,22u-20%-250V | WT-77/1-MKSE-20 | | 1 | | | 20 | b | 8,- | | NIFLEX |
| 242 | C965 | Kondensator 02/E-4,7u-160V-typ2 | EN-77/3281-38 | 1158-127-025-534 | 1 | | | 20 | b | 5,- | | ELWA |
| 243 | C906 | Kondensator 02/T-E-4700u-25V-typ 2 | EN-77/3281-38 | 1158-127-072-942 | 1 | 2 | | 10 | b | 51,- | | ELWA |
| 244 | | Zespół cewek oddychających T2C 13 | WT-78/NPM-14/ /ZPT-055 | 1158-821-950-021 | 1 | 2 | | | | 240,- | | ZPT Białystok |
| 245 | | Podst.kineskopu | EN-74/3312-03 ark.13 | 1158-631-109-014 | 1 | 1 | | | | 4,- | | ELWA |
| 246 | PG851 | Gniazdo słuchaw.G S-2-3-25/070/ /10 | EN-76/3384-31 | 1158-643-200-037 | 1 | 1 | | | | 9,- | | ELWA |
| 247 | | wtyk antenowy koncent.WZA 1/6 -071 | ZN-78/NPM-14/T15- | | 1 | | | | | 11,- | | ELWA |
| 248 | SPZ-34 | Przełączacz Pz K1 IIW2 OMyp2P | EN-75/3064-02 | 1131-374-020-607 | 1 | | | | | 32,- | | POLAN Szczecin |
| 249 | GL851 | Głośnik GD-7-13/1,5/8 | EN-67/3242-01 | 1158-710-220-223 | 1 | 1 | | | | 46,- | | TONSIL |
| 250 | | Antena ATP 15/1 | ZN-78/NPM-14/T15- -090 | 1153-532- | 1 | 2 | | | | | | ZZE Białogard |
| 251 | | Zespół2 program.Preomat P 4/4 | 1532-054 | 1158-824 | 1 | 2 | | | | | | ELEKTROMO- DUL |
| 252 | PK851 | Przel.klawiszowy 620.02.967.1 | EN-74/3384-02/01 | | 1 | 2 | | | | 3,- | | ELTRA |
| 253 | | Wkładka bezpiecznikowa WTA-T- -315mA/250V | PN-77/E-06170 | | 1 | 15 | | 20 | b | | | |
| 254 | PG801 | Gniazdo G15-1 | WT-74/923-085-091 /242 ark.05 | | 1 | 2 | | | | 16,- | | ELTRA |
| 255 | V6 | Nasadka N7-2 | WT-74/923-085-091 /242 ark.3 | 1158-643-057 | 1 | | | | | 10,- | N-653 | ELTRA |
| 256 | V352 | Nasadka N2-1 | WT-74/923-085-091 /242 ark.1 | 1158-643-016 | 1 | | | | | 6,- | | ELTRA |
| 257 | V802 | Nasadka N3-1 | WT-74/923-085-091 /242 ark.2 | 1158-643-102-031 | 1 | | | | | 7,- | | ELTRA |
| 258 | V951 | Nasadka N7-1 | WT-74/923-085-091 /242 ark.3 | 1158-643-102-044 | 1 | | | | | 10,- | N-653 | ELTRA |
| 259 | V951 | Nasadka NZZ-3 | EN-76/3384-05 ar.4 | 1158-643- | 1 | | | | | 27,- | | ELTRA |
| 260 | V801 | Nasadka N10-1 | WT-74/923-085-091 /242 ark.4 | 1158-643-102-060 | 1 | | | | | 12,- | N-625 | ELTRA |
| 261 | V803 | Nasadka N2-1 | WT-74/923-085-091 /242 ark.1 | 1158-643-102-016 | 1 | | | | | 6,- | N-625 | ELTRA |

| 1 | 2 | 3 | 4 | 5 | 6 | 7 | 8 | 9 | 10 | 11 | 12 | 13 |
|-----|------------|--|--------------------------------|--------------------|---|---|---|---|----|---------|-------|------------------|
| 262 | W804, W901 | Nasadka N7-1 | WT-74/923-085-091/242 ark.3 | 1158-643-102-044 | 2 | | | | | 10,- | N-625 | ELTRA |
| 263 | W807 | Nasadka N1 | D-2170-053 | | 1 | | | | | | | UNIMOR |
| 264 | W808 | Nasadka N3-1 | WT-74/923-085-091-242 ark.2 | 1158-643-102-091 | 1 | | | | | 7,- | N-625 | ELTRA |
| 265 | | Wtyk kompletny antenowy | 9150-1100 | | 1 | 1 | | | | | | UNIMOR |
| 266 | ET11 | Głowica zintegrowana ZTG40.25.01.65.02 | WT-4711-2048 | | 1 | 2 | | | | 1.300,- | | WTZ |
| 267 | | Wspornik gniazda komple- tnego C | C-3711-066 | | 1 | 2 | | | | | | WTZ |
| 268 | D2101 | Dławik 30uH | DW-328-392 | | 1 | | | | | 6,- | | POLFER |
| 269 | D2102 | Dławik 27uH | DW-328-272 | | 1 | | | | | 6,- | | POLFER |
| 270 | F101 | Cewka 7x7 508 | L9/W-4391-0043 | 1158-146-850-305 | 1 | 2 | | | | | | POLFER |
| 271 | F102, F104 | Cewka 7x7 509 | L9/W-4391-0043 | 1158-146-850-305 | 2 | 2 | | | | | | POLFER |
| 272 | F103, F107 | Cewka 7x7 510 | L9/W-4391-0043 | 1158-146-850-305 | 2 | 2 | | | | | | POLFER |
| 273 | F105 | Cewka 7x7 512 | L9/W-4391-0043 | 1158-146-850-305 | 1 | 2 | | | | | | POLFER |
| 274 | F106 | Cewka 7x7 513 | L9/W-4391-0043 | 1158-146-950-305 | 1 | 2 | | | | | | POLFER |
| 275 | F108 | Cewka 7x7 514 | L9/W-4391-0043 | 1158-146-950-305 | 1 | 2 | | | | | | POLFER |
| 276 | F109 | Cewka 7x7 450 | L9/W-4391-0043 | 1158-146-950-305 | 1 | 2 | | | | | | POLFER |
| 277 | F110 | Cewka 7x7 515 | L9/W-4391-0043 | 1158-146-950-305 | 1 | 2 | | | | | | POLFER |
| 278 | F111 | Cewka 7x7 516 | L9/W-4391-0043 | 1158-146-950-305 | 1 | 2 | | | | | | POLFER |
| 279 | FC201 | Filtr ceram.monolit. FCM-6,5-180-20-25/070/10 | WT-77/L-5/163 | | 1 | | | | | | N-625 | CERAD |
| 280 | F201 | Cewka 7x7 451 | L9/W-4391-0043 | 1158-146-343-00400 | 1 | 2 | | | | | | POLFER |
| 281 | L951, L952 | Dławik DR 10uH/1,5A | WT-4362-0009 | | 2 | | | | | 4,- | | POLFER |
| 282 | L953 | Dławik DL204 | WT-79/MEM-14/ZPT-003 | | | | | | | | | Lipak |
| 283 | L954 | Cewka liniowości TVT-13 | WT-78/MEM-14/ZPT-0054 | | 1 | 2 | | | | 25,- | | ZPT Białystok |
| 284 | TR951 | Transformator sterujący TS 13 | WT-78/MEM-14/ZPT-0053 | 1158-822-220-390 | 1 | 1 | | | | 12,- | | ZPT Białystok |
| 285 | TR952 | Transformator TVL 53 | WT-78/MEM-14/ZPT-0052 | 1158-822-102-339 | 1 | 3 | | | | 220,- | | ZPT Białystok |
| 286 | | Transformator sieciowy TS50/11 | WT/D-4247-0351-01 | 1158-141 | 1 | 3 | | | | | | ZATRA |

| 1 | 2 | 3 | 4 | 5 | 6 | 7 | 8 | 9 | 10 | 11 | 12 | 13 |
|-----|---|--|------------------------------|------------------|----|---|---|----|----|------|-------|---------|
| 287 | G903 | Wtyk akumulatora WZZ-02 | HN-72/3384-05 ark.2 | 1158-643-301-022 | 1 | | | | | 8,- | | ELTRA |
| 288 | BZ901 | Wkładka bezpiecznikowa WTA-T-315 mA/250V | PN-77/E-06170 | | | | | 10 | b | 3,- | | RWN |
| 289 | | Sprężyna kontaktowa do EZ 901 | C-2570-016 | 8832-910-662-080 | | | | | | 2,- | N-653 | UNIMOR |
| 290 | W806 | Nasadka W7-1 | WT-74/923-083-091/242 ark.03 | | 1 | | | | | 10,- | | ELTRA |
| 291 | G902 | Wtyk sieciowy WZZ-04 | ZN-76/MPN-14-T15-098 ark.01 | | 1 | | | | | 9,- | | ELTRA |
| 292 | | Kolek kontaktowy jedno-stronny | 1437-043 | | 76 | | | | | | | UNITECH |
| 293 | | Kolek kontaktowy dwu-stronny | D-1437-272 | | 44 | | | | | 2,- | | UNITECH |
| 294 | | Kolek kontaktowy 1-RWN/10 Typ A | | | 9 | 5 | | | | 0,30 | N-625 | STOCKO |
| 295 | PG101, PG102, PG201, PG251, PG301, PG351, PG951 | Gniazdo MG-8 | ZN-78/MPN-14/T15-132 | | 7 | | | | | 8,- | | ELTRA |
| 296 | PG952 | Gniazdo MG14 | ZN-78/MPN-14/T15-132 | | 1 | | | | | 14,- | N-625 | ELTRA |
| 297 | MF1003-3 | Moduł fonii | WT-79/T18-9150-2200 | | 1 | 2 | | | | | | UNIMOR |
| 298 | EZ1001-1 | Blok zasilania | WT-79/T18-8150-2500 | | 1 | 2 | | | | | | UNIMOR |
| 299 | MG1002-1 | Moduł głowicy | WT-79/T18-9150-2010 | | 1 | 2 | | | | | | UNIMOR |
| 300 | MF1003-1 | Moduł cz.pośredniej | WT-79/T18-9150-2100 | | 1 | 2 | | | | | | UNIMOR |
| 301 | WV1004-1 | Moduł odchyl.pionowego | WT-79/T18-9150-2300 | | 1 | 2 | | | | | | UNIMOR |
| 302 | WV1003 | Moduł wizji | WT-79/T18-9150-2350 | | 1 | 2 | | | | | | UNIMOR |
| 303 | NS1002-1 | Moduł synchronizacji | WT-79/T18-9150-2250 | | 1 | 2 | | | | | | UNIMOR |
| 304 | ME 1001 | Moduł odchyl.pionowego | WT-79/T18-9150-2950 | | 1 | 2 | | | | | | UNIMOR |

ZASTOSOWANE OZNACZENIA

1. w kolumnie 8 - "rodzaj opakowania"
 x - pudełko tekturowe
 y - torbka foliowa
 z - opakowanie zawierające torbki foliowe wkładane do pudełek tekturowych

2. w kolumnie 10 - "sposób zamieszczania metek"

z - metka naklejana na zewnątrz opakowania b - metka luźna w opakowaniu c - metka łączona z detałem

PRODUCENT

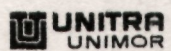

GDAŃSKIE ZAKŁADY ELEKTRONICZNE „UNIMOR” 80-822 Gdańsk, ul. Rzeźnicka 54/56

site: www.unimor.pigwa.net

scan: stryker2(at)o2.pl