

UNIMOR

Odbiorniki telewizyjne

Neptun 653

453

453A

KATALOG ZESPOŁÓW

I CZĘŚCI ZAMIENNYCH

Niniejszy dokument stanowi katalog części zamiennych koniecznych do dokonywania napraw. Ilość części uwzględniona w rubryce 7 jest ilością na 100 szt., które powinny nadejść do hurtowni WPHW patronackiego wraz z pierwszą partią sprzętu.

Za kompletność katalogu odpowiada producent sprzętu. W przypadku braku jakiegokolwiek elementu lub podzespołu niezbędnego do dokonywania napraw, a nie umieszczonego w katalogu - producent jest zobowiązany przestać brakujący element w ciągu 14 dni od daty zamówienia.

KATALOG zespołów i części zamiennych

DO ODBIORNIKÓW TELEWIZYJNYCH "NEPTUN" 653, 453, 453A

Dane dotyczące wydawanych uzupełnień katalogu.

| Numer uzupełnienia | Okres wydania uzupełnienia | | Termin wyekspirow. obowiąz- ku dostaw części wycof. z produkcji | Oznaczenie typu wy- robu po wprowadzo- nych zmianach |
|-----------------------|----------------------------|-----|---|--|
| | miesiąc | rok | | |
| | | | | |
| | | | | |
| | | | | |
| | | | | |
| | | | | |
| | | | | |
| | | | | |
| | | | | |
| | | | | |

PRODUCENT: UNITRA-UNIMOR GDAŃSKIE ZAKŁADY ELEKTRONICZNE ul. Rzeźnicka 54/56 80-958 GDAŃSK 1

ODBIORNIK KOMPLETNY NEPTUN 653

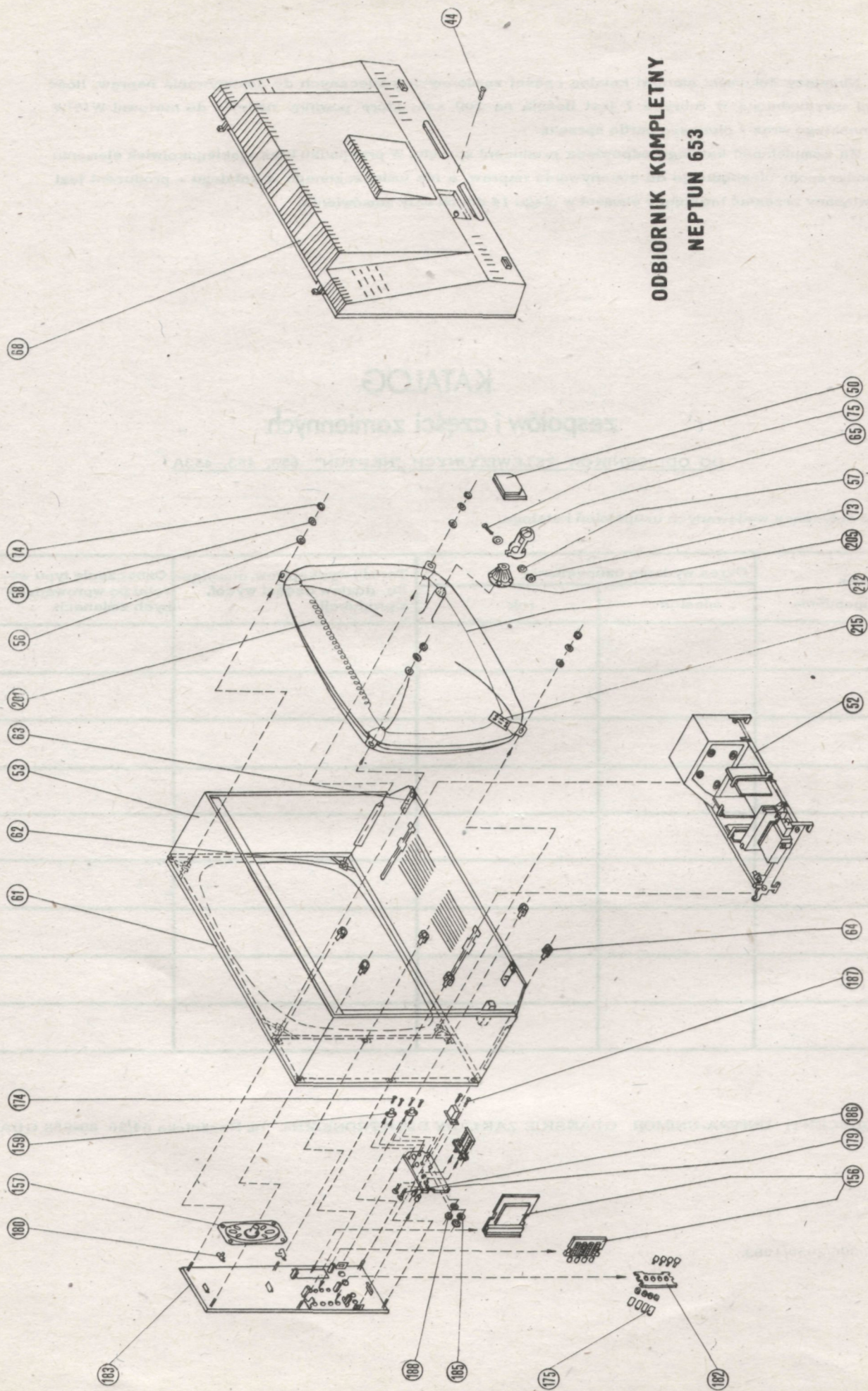

ODBIORNIK KOMPLETNY NEPTUN 453

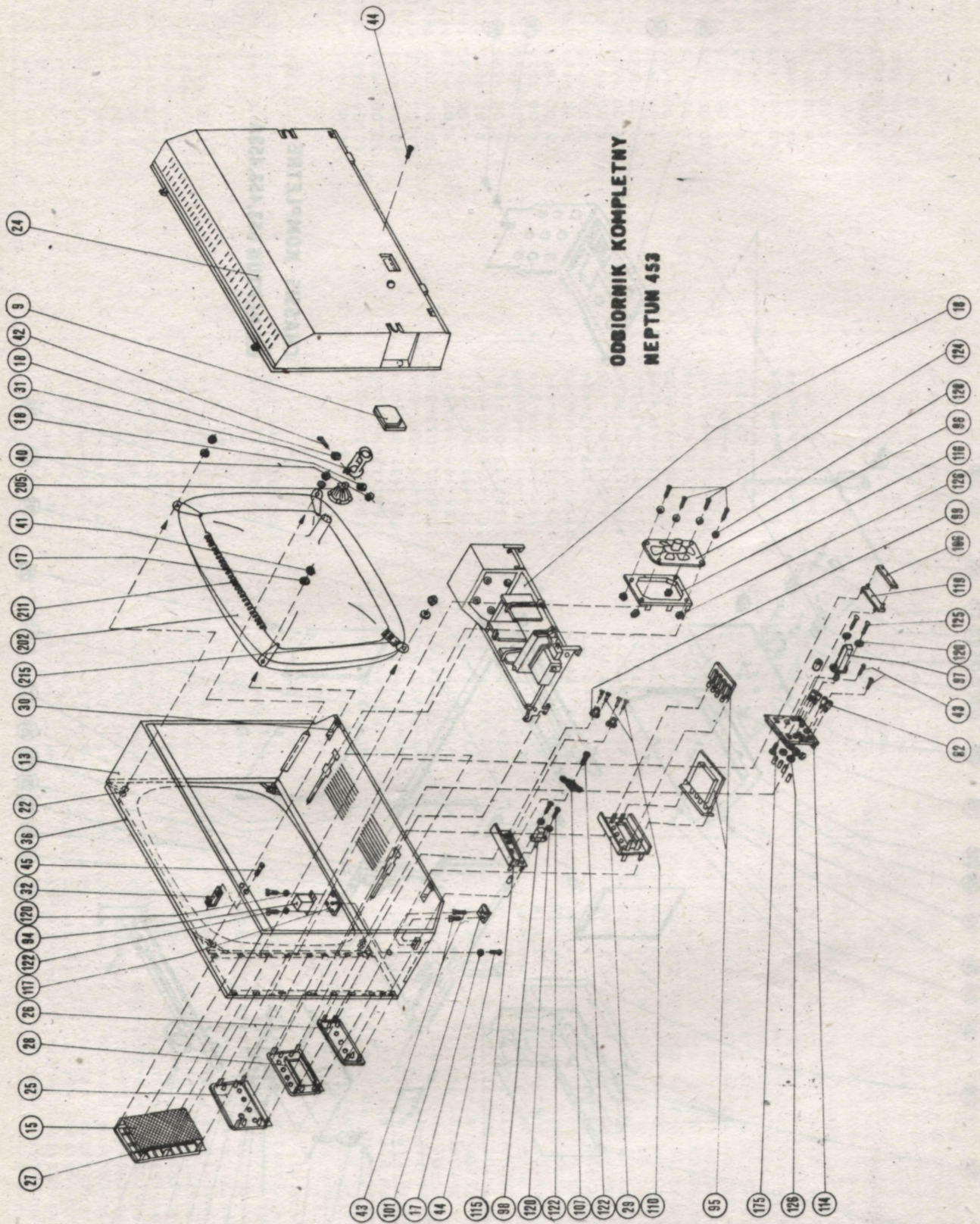

O.T. NEPTUN 653,453,453A

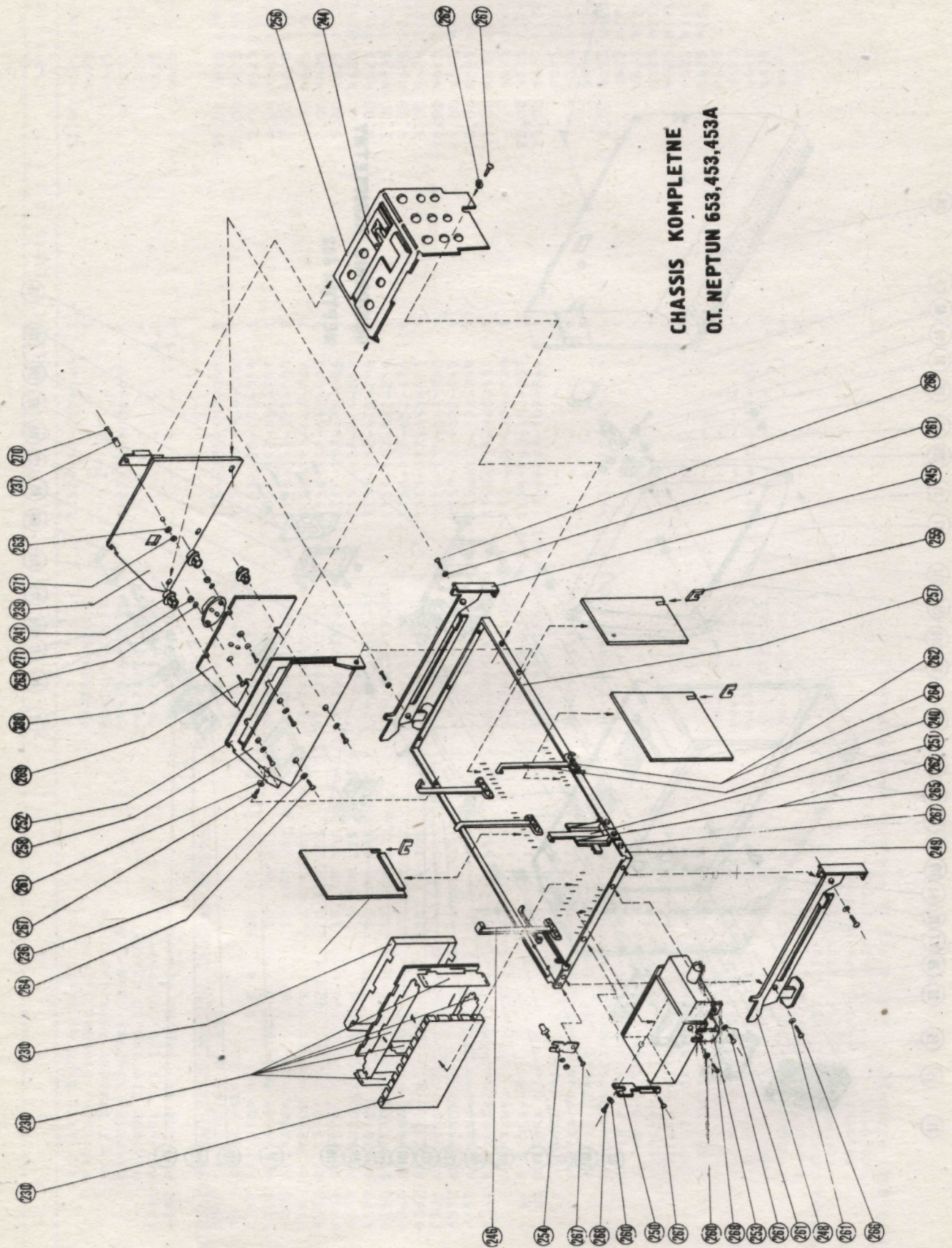

ZESTAWIENIE CZĘŚCI ZAMIENNYCH PŁOKÓW, MODUŁÓW I ZESPÓŁÓW OTV NEPTUN 453 I 653 ZAWIERA 13 STRON

SKOROWIDZ ZESPÓŁÓW

| | |
|--|-----------|
| OBROBIENIE KOMPL OTV NEPTUN 453 9453-0000-1 | STRONA 1 |
| OBROBIENIE KOMPL OTV NEPTUN 653 9653-0000-1 | STRONA 1 |
| ZESPÓŁÓW OTV NEPTUN 453 LP. 1,5,6,7,8 | STRONA 2 |
| ZESPÓŁÓW REGULACJI 9653-3000-1 | STRONA 3 |
| ZESPÓŁÓW KINESKOPU 9631-3000-5 I 9631-3000-6 | STRONA 4 |
| CHASSIS ZŁOZONEGO 9625-2000/A-3 | STRONA 5 |
| PŁYTY GŁÓWNEJ 9625-2100/A-4 | STRONA 6 |
| MODUŁ GŁÓWNY MG-1001 9625-2200-1 | STRONA 8 |
| MODUŁ P CZ MP-1001 T4-a-4492-001-1 | STRONA 8 |
| MODUŁ FONII MF-1002 T4-C-4492-007-1 | STRONA 10 |
| MODUŁ SYNCHRONIZACJI MS-1001 9625-2500-1 | STRONA 10 |
| MODUŁ RAMKI MW-1002 9625-2400-1 | STRONA 11 |
| MODUŁ WIZJI MW-1002 T4-C-4492-006-1 | STRONA 12 |
| ZALĄCZNIK DOTYCZĄCY OT NEPTUN 453A | STRONA 13 |

POZOSTAŁE PARAMETRY WYBIORCZE PRZESIEGU:

KODY STRUKTURY D11K3M40101S1U1W1Y1C1H2J5J6

KODY GRUP OZN. SCH.

PRZEDZIAŁY INDEKSÓW

KODY KAT. CZĘŚCI

ZESTAWIENIE CZĘŚCI ZAMIENNYCH BLOKOW, MODUŁOW I ZESPÓŁOW OTV NEPTUN 453 I 653

| L I NR P IM.SCH. I | I | NAZWA I OZNACZENIE CZĘŚCI | I | NR NORMY I WARUNKOW TECH. | I | INDEKS I KTM | I ILOSC I A I B I O I M I O P A K I | CENA I Z A S T I | I P R O D U - C E N T | STR. |
|--|----|--|---|------------------------------|---|-----------------|--|---------------------|--------------------------|---------|
| | | | | | | | | | | |
| 1 | 1 | 1 | 1 | 4 | 1 | 5 | 1 6 1 7 1 8 1 9 1 1 0 1 1 1 | 11 | 1 1 2 1 1 3 | |
| CZĘŚCI ODBIORNIKA KOMPL OTV NEPTUN 453 9453-0000-1 | | | | | | | | | | |
| 1 | 1 | TRANSFORMATOR SEPARUJACY KOMPL 9432-3000-2 | | | | | | | | UNIMOR |
| 2 | 2 | WKLADKA TOPIKOWA APARAT ZWL WTA-T 1,25A 250V PN-77/E-06170 | | | | | | | | ESP |
| 3 | 3 | LISTA PRZEWODOW LP-9625-0000 | | | | | | | | TECHNOM |
| 4 | 4 | ZESPOL KINESKOPU 9631-3000-5 | | | | | | | | UNIMOR |
| 5 | 5 | ZESPOL ZARZADZAJACO-PROGRAMUJACY 9653-3300-2 | | | | | | | | ZWM |
| 6 | 6 | ZESPOL GLOSNIKA 9431-4000-3 | | | | | | | | UNIMOR |
| 7 | 7 | ZESPOL POTENCJOMETROW 9453-3000-1 | | | | | | | | ZWM |
| 8 | 8 | ZESPOL GMIAD 9453-2000-1 | | | | | | | | ZWM |
| 9 | 9 | MODUL WIZJI MW-1002 T4-C-4402-0006-1 | | | | | | | | MIFLEX |
| 10 | 10 | CHASSIS ZLOZONE 9625-2000/A-3 | | | | | | 525.00 | | N625 |
| 11 | 11 | USZCZELKA D-2170-251-1 | | | | | | | | UNIMOR |
| 12 | 12 | OSUROWA OTV NEPTUN 453 /RFZ OKUR/ | | | | | | | | ERG |
| 13 | 13 | OSUROWA OTV NEPTUN 453 9453-1000-1 | | | | | | | | ZELOR |
| 14 | 14 | KLOCEK GREWNIANY DO OSUROW OTV | | | | | | | | ZELOR |
| 15 | 15 | TKANINA GLOSNIKOWA L-5266 CZARNA | | | | | | | | N625 |
| 16 | 16 | KOLF SPECJALNY D-1490-032-1 | | | | | | | | ZELOB |
| 17 | 17 | PODKLADKA D-1610-046-1 | | | | | | | | |
| 18 | 18 | PODKLADKA D-1656-0017-1 | | | | | | | | N625 |
| 19 | 19 | PODKLADKA D-2170-010-1 | | | | | | | | UNIMOR |
| 20 | 20 | TRZYMACZ SZNURA SIERNIOF60 C-2170-0330-1 | | | | | | | | UNIMOR |
| 21 | 21 | NOZKA C-2170-081-1 | | | | | | | | UNIMOR |
| 22 | 22 | KOLF KINFSKOPOWY D-2170-100-1 | | | | | | | | UNIMOR |
| 23 | 23 | PLYTA PRZEDNIA 20" A-2170-148-1 | | | | | | | | UNIMOR |
| 24 | 24 | SCIANKA TYLNA H-2170-152-1 | | | | | | | | UNIMOR |
| 25 | 25 | PLYTKA DEKORACYJNA CZ I C-2170-162-1 | | | | | | | | UNIMOR |
| 26 | 26 | PLYTKA DEKORACYJNA CZ IV C-2170-163-3 | | | | | | | | UNIMOR |
| 27 | 27 | PLYTKA DEKORACYJNA C-2170-167-1 | | | | | | | | UNIMOR |
| 28 | 28 | PLYTKA DEKORACYJNA CZ III R-2170-168-1 | | | | | | | | UNIMOR |
| 29 | 29 | PLYTKA MOSNA ZESPOLU PROGRAM P-2170-169-1 | | | | | | | | UNIMOR |
| 30 | 30 | ZACZEP SCIANKI TYLNEJ C-2170-177-1 | | | | | | | | UNIMOR |
| 31 | 31 | TRZYMACZ MW C-2170-269-1 | | | | | | | | UNIMOR |
| 32 | 32 | WIESZAK D-2210-205-1 | | | | | | | | UNIMOR |
| 33 | 33 | ZAPINKA D-2240-0038-2 | | | | | | | | UNIMOR |
| 34 | 34 | KAPTUREK D-2340-047-1 | | | | | | | | UNIMOR |
| 35 | 35 | OSEJMA C-150X4,8 | | | | | | | | UNIMOR |
| 36 | 36 | PLYTA CZOLOWA 9431-2000-1 | | | | | | | | UNIMOR |
| 37 | 37 | PLYTKA DEKORACYJNA KOMPL 9431-4100-1 | | | | | | | | UNIMOR |
| 38 | 38 | ZSZYWK TAPICERSKA 8X11,5 | | | | | | | | UNIMOR |
| 39 | 39 | ZSZYWK TAPICERSKA 8X11,5 | | | | | | | | UNIMOR |
| 40 | 40 | NAKRETKA STALOWA M4-6-II ZN | | | | | | | | UNIMOR |
| 41 | 41 | NAKRETKA STALOWA M5-6-II ZN | | | | | | | | UNIMOR |
| 42 | 42 | WKREFT STALOWY M4X14-4,8-II ZN | | | | | | | | UNIMOR |
| 43 | 43 | WKREFT DO PLACH A 6B2,9X13 ZN | | | | | | | | UNIMOR |
| 44 | 44 | WKREFT DO PLACH A 6B3,9X19 ZN | | | | | | | | UNIMOR |
| 45 | 45 | WKREFT STALOWY M3X25-4,8-I ZN | | | | | | | | UNIMOR |
| 46 | 46 | WAZ ELEKTROIZOLACYJNY Z PCW 4X0,5 CZARNY | | | | | | | | UNIMOR |
| CZĘŚCI ODBIORNIKA KOMPL OTV NEPTUN 653 9653-0000-1 | | | | | | | | | | |
| 47 | 47 | BZ901 WKLADKA TOPIKOWA APARAT ZWL WTA-T 1,25A 250V PN-77/E-06170 | | | | | | | | ESP |

| 1 | 2 | 3 | 4 | 5 | 6 | 7 | 8 | 9 | 10 | 11 | 12 | 13 |
|-----|--|--------------------|----------------------|------------------|----|---|---|---|----|-------|------|-------------|
| 103 | W3 NASADKA N7-1 | | WT74/923-085-091/242 | 1158-643-102-044 | 1 | | | | | | | |
| 104 | W4 NASADKA N3-1 | | WT74/923-085-091/242 | 1158-645-102-031 | 1 | | | | | 25.00 | N625 | ELTRA |
| 105 | W5 NASADKA N2-1 | | WT74/923-085-091/242 | 1158-643-102-016 | 1 | | | | | 20.00 | N625 | ELTPA |
| 106 | W6 ŁĄCZOWNIKA LUTOWNICZA ŁL-8 | B WSP C-3571-001-5 | ZN-59/MPC-14/T20-002 | 1158-620-700-018 | 1 | | | | | | | N625 ELTPA |
| 107 | W7 ŁĄCZOWNIKA PRZEJSCIONA D-4572-0001-1 | | WT-01/80 | 8832-910-291-187 | 1 | | | | | | | UWITECH |
| 108 | W8 SZUR PRZYŁĄCZENIOWY SP-102 Dł 2,50 M | | | | 1 | | | | | | | UWIMOR |
| 109 | W9 STYK 73-2321.01.1 | | | | 1 | | | | | | | UWIMOR |
| 110 | W10 NIT RURKOWY WZMOCNIOWY D-1530-005-2 | | | | 1 | | | | | | | SINPO |
| 111 | W11 NASADKA D-2170-053-1 | | | | 1 | | | | | | | N625 ELTPA |
| 112 | W12 KLIPS 10-7 C-2170-056-1 | | | | 1 | | | | | | | N625 UNIMOR |
| 113 | W13 KLIPS 3-2 D-2170-058-1 | | | | 2 | | | | | | | N625 UNIMOR |
| 114 | W14 PŁYTKA MONTAZOWA B-2170-164-1 | | | | 2 | | | | | 6.00 | | N625 UNIMOR |
| 115 | W15 PŁYTKA GŁOSNIKA C-2170-165-1 | | | | 1 | | | | | | | N625 UNIMOR |
| 116 | W16 PŁYTKA GŁOSNIKA C-2170-166-1 | | | | 1 | | | | | | | N625 UNIMOR |
| 117 | W17 WSPORNIK TRANSFORMATORA C-2170-212-1 | | | | 1 | | | | | | | N625 UNIMOR |
| 118 | W18 ZAPISKA D-2249-0038-2 | | | | 1 | | | | | 1.00 | | N625 UNIMOR |
| 119 | W19 WSPORNIK D-2320-035-1 | | | | 3 | | | | | | | N625 UNIMOR |
| 120 | W20 PODKŁADKA STALOWA 3,2 ZN | | PN-78/M-82007 | | 1 | | | | | | | N625 |
| 121 | W21 PODKŁADKA STALOWA 3,2 ZN | | PN-78/M-82007 | | 6 | | | | | | | N625 |
| 122 | W22 WKRETY DO BLACH A GR2,0X9,5 ZN | | PN-79/M-83106 | | 4 | | | | | | | N625 |
| 123 | W23 WKRETY DO BLACH A GR2,0X9,5 ZN | | PN-79/M-83106 | | 2 | | | | | | | N625 |
| 124 | W24 WKRETY STALOWY M3X6-4,8-I ZN | | PN-74/M-82227 | | 3 | | | | | | | N625 |
| 125 | W25 WKRETY STALOWY M3X8-4,8-I ZN | | PN-74/M-82227 | | 4 | | | | | | | N625 |
| 126 | W26 NAKRĘTKA STALOWA M3-6-I ZN | | PN-75/M-82144 | | 2 | | | | | | | N625 |
| 127 | W27 NAKRĘTKA STALOWA M3-6-I ZN | | PN-75/M-82144 | | 2 | | | | | | | N625 |
| 128 | W28 PRZEWOD OMYP 2X0,50 | | PN-73/F-90103 | | 57 | | | | | | | N625 |
| 129 | W29 PRZEWOD TLY 1X0,50 CZARNY | | PN-74/T-90204 | | 12 | | | | | | | N150 |
| 130 | W30 PRZEWOD TLY 1X0,20 CZAPNY | | PN-74/T-90204 | | 33 | | | | | | | N625 |
| 131 | W31 PRZEWOD TLY 1X0,20 ZIELONY | | PN-74/T-90204 | | 60 | | | | | | | N625 |
| 132 | W32 PRZEWOD TLY 1X0,20 NIEBIESKI | | PN-74/T-90204 | | 35 | | | | | | | N625 |
| 133 | W33 PRZEWOD TLY 3X0,20 | | PN-74/T-90211 | | 65 | | | | | | | N625 |
| 134 | W34 PRZEWOD TLY 4X0,20 | | PN-74/T-90211 | | 40 | | | | | | | N150 |
| 135 | W35 PRZEWOD TLY 6X0,20 | | PN-74/T-90211 | | 70 | | | | | | | N625 |
| 136 | W36 PRZEWOD TLY 8X0,20 | | PN-67/C-80209 | | 57 | | | | | | | N625 |
| 137 | W37 WAZ ELEKTROIZOLACYJNY Z PCW 2X0,5 | | PN-67/C-80209 | | 16 | | | | | | | N625 |
| 138 | W38 WAZ ELEKTROIZOLACYJNY Z PCW 3X0,5 | | PN-67/C-80209 | | 2 | | | | | | | N625 |
| 139 | W39 WAZ ELEKTROIZOLACYJNY Z PCW 4X0,5 | | PN-67/C-80209 | | 22 | | | | | | | N625 |

CZESCI ZESPOLU REGULACJI 9-53-3000-1

| | | | | | | | | | | | | |
|-----|--|-----------------|----------------------|------------------|---|--|--|--|--|--------|------|--------|
| 140 | R810 REZYSTOR OWZ-2A 1 W | 33 OM 10% | WT-77/L7/072 | 1158-112-647-027 | 1 | | | | | 4.00 | | TELP0D |
| 141 | R813 REZYSTOR OWZ-2A 0,25 W | 18 KOM 10% | WT-77/L7/072 | 1158-112-641-238 | 1 | | | | | 2.00 | N625 | TELP0D |
| 142 | R814 REZYSTOR OWZ-2A 0,25 W | 470 KOM 10% | WT-77/L7/072 | 1158-112-641-403 | 1 | | | | | 2.00 | N625 | TELP0D |
| 143 | R852 POTENCJOMETR PR-185 | 4,7 KOM A 16PS | WT-74/L7/152 | 1158-114-041-313 | 1 | | | | | 34.00 | N150 | TELP0D |
| 144 | R853 POTENCJOMETR PR-185 | 1 KOM A 16PS | WT-74/L7/152 | 1158-114-041-191 | 1 | | | | | 34.00 | N150 | TELP0D |
| 145 | R858 REZYSTOR OWZ-2A 0,25 W | 6,8 KOM 10% | WT-77/L7/072 | 1158-112-641-180 | 1 | | | | | 2.00 | | TELP0D |
| 146 | R859 POTENCJOMETR PR-185 | 1 MOM A 16PS | WT-74/L7/152 | 1158-114-041-074 | 1 | | | | | 34.00 | N150 | TELP0D |
| 147 | R860 POTENCJOMETR PR-185 | 10 KOM A 16PS | WT-74/L7/152 | 1158-114-040-491 | 1 | | | | | 34.00 | N432 | TELP0D |
| 148 | R861 REZYSTOR OWZ-2A 0,25 W | 33 KOM 20% | WT-77/L7/072 | 1158-112-641-724 | 1 | | | | | 2.00 | | TELP0D |
| 149 | R862 REZYSTOR OWZ-2A 0,25 W | 1,5 MOM 20% | WT-77/L7/072 | 1158-112-641-826 | 1 | | | | | 2.00 | N625 | TELP0D |
| 150 | C803 KONDENSATOR KSE-011-02/2 | 100NF 20% 1000V | BN-77/3281-40 | 1158-124-504-356 | 1 | | | | | 17.00 | N625 | MFLEX |
| 151 | C852 KONDENSATOR KCR-1R-U-3X8 | 56-J-400-658 | BN-78/3281-33 | 1158-133-191-782 | 1 | | | | | 8.00 | N625 | CERAD |
| 152 | C854 KONDENSATOR KSE-011-02/2 | 150NF 20% 250V | BN-77/3281-40 | 1158-124-503-559 | 1 | | | | | 12.00 | | MFLEX |
| 153 | C855 KONDENSATOR KSE-011-02/3 | 4,7NF 20% 630V | BN-77/3281-40 | 1158-124-503-559 | 1 | | | | | 6.00 | | MFLEX |
| 154 | L801 DŁAWIK PRZECIWDZIAŁOWY 170 MH/1 | A/666 | WT/0-4245-0129 | 1158-520-230-009 | 1 | | | | | 169.00 | N625 | ZATRA |
| 155 | TR801 TRANSFORMATOR SEPARACYJNY C-4245-368-01 | | WT/0-4245-01368 | 1158-141-904-010 | 1 | | | | | 825.00 | N429 | RIAZET |
| 156 | ZIP ZESPOL ZAPACZAJACO-PROGRAMUJACY ZTP-20410W | | WT-77/MPW-14/7PT-039 | 1158-824-100-709 | 1 | | | | | 189.00 | N625 | TONSL |
| 157 | G1801 GŁOSNIK 6010-16/4 | 8 OM | BN-79/3242-01 | 1158-710-230-221 | 1 | | | | | | | |

| 1 | 2 | 3 | 4 | 5 | 6 | 7 | 8 | 9 | 10 | 11 | 12 | 13 |
|---|-----------|---|----------------------|------------------|-----|-----|-----|-----|-----|-----|-----|-----|
| 158 | PK1 | PRZELACZNIK SEGMENTOWY 620,02,075,1 | BN-74/3384-02 | - | 1 | 1 | 1 | 1 | 1 | 1 | 1 | 1 |
| 159 | G9 | GWIADZO MAGNETOFONOWE GM-345-1-666 | BN-72/3384-07,03 | 1158-643-210-010 | 1 | 1 | 1 | 1 | 1 | 1 | 1 | 1 |
| 160 | G10 | GWIADZO MAGNETOFONOWE GM-500-2-666 | BN-76/3384-07,36 | 1158-643-210-137 | 1 | 1 | 1 | 1 | 1 | 1 | 1 | 1 |
| 161 | G11 | GWIADZO REFZP APARAT GRA-II 125A 250V | PN-77/F-06170 | - | 1 | 1 | 1 | 1 | 1 | 1 | 1 | 1 |
| 162 | W1 | NASADKA N10-1 | WT74/923-085-091/242 | 1158-643-102-060 | 1 | 1 | 1 | 1 | 1 | 1 | 1 | 1 |
| 163 | W3 | NASADKA N7-1 | WT74/923-085-091/242 | 1158-643-102-044 | 1 | 1 | 1 | 1 | 1 | 1 | 1 | 1 |
| 164 | W4 | NASADKA N3-1 | WT74/923-085-091/242 | 1158-643-102-031 | 1 | 1 | 1 | 1 | 1 | 1 | 1 | 1 |
| 165 | W5 | NASADKA N2-1 | WT74/923-085-091/242 | 1158-643-102-016 | 1 | 1 | 1 | 1 | 1 | 1 | 1 | 1 |
| 166 | W6 | NASADKA N1-1 | WT74/923-085-091/242 | 1158-643-102-001 | 1 | 1 | 1 | 1 | 1 | 1 | 1 | 1 |
| 167 | K10 | KONCOWKA LUTOWNICZA KL-8 B WSP C-3571-001-5 | ZN-59/WPC-14/T20-002 | 1158-620-700-018 | 1 | 1 | 1 | 1 | 1 | 1 | 1 | 1 |
| 168 | K10 | KONCOWKA LUTOWNICZA K13-1 AG | ZN-70/WPM-14/T15-086 | 1158-620-700-018 | 1 | 1 | 1 | 1 | 1 | 1 | 1 | 1 |
| 169 | SZNR | PRZYŁACZENIOWY SP-102 D 2,50 M | WT-01/A0 | 1158-620-200-215 | 1 | 1 | 1 | 1 | 1 | 1 | 1 | 1 |
| 170 | STYK | 75.2321.01.1 | ZN-80/T18-075 | 8832-910-665-083 | 2 | 2 | 2 | 2 | 2 | 2 | 2 | 2 |
| 171 | ZESPOL | POTENCJOMETRÓW 9653-3200-1 | - | - | 1 | 1 | 1 | 1 | 1 | 1 | 1 | 1 |
| 172 | ZESPOL | WYŁACZNIKÓW 7 GNIAZDAMI 9653-3100-1 | - | - | 1 | 1 | 1 | 1 | 1 | 1 | 1 | 1 |
| 173 | ZESPOL | 7 GNIAZDAMI 9653-3100-1 | - | - | 1 | 1 | 1 | 1 | 1 | 1 | 1 | 1 |
| 174 | ZESPOL | 7 GNIAZDAMI 9653-3100-1 | - | - | 1 | 1 | 1 | 1 | 1 | 1 | 1 | 1 |
| 175 | NIT | RURKOWY WZMOCNIOWY D-1530-005-1 | - | - | 1 | 1 | 1 | 1 | 1 | 1 | 1 | 1 |
| 176 | GAZKA | C-1810-011/A-1 | - | - | 1 | 1 | 1 | 1 | 1 | 1 | 1 | 1 |
| 177 | NASADKA | D-2170-053-1 | - | - | 1 | 1 | 1 | 1 | 1 | 1 | 1 | 1 |
| 178 | KLIPS | 10-7 C-2170-056-1 | - | - | 1 | 1 | 1 | 1 | 1 | 1 | 1 | 1 |
| 179 | KLIPS | 3-2 D-2170-058-1 | - | - | 1 | 1 | 1 | 1 | 1 | 1 | 1 | 1 |
| 180 | PŁYTKA | WONTAZOWA C-1770-146-1 | - | - | 1 | 1 | 1 | 1 | 1 | 1 | 1 | 1 |
| 181 | KLIPS | GŁOSNIKA C-2240-074-1 | - | - | 1 | 1 | 1 | 1 | 1 | 1 | 1 | 1 |
| 182 | ZAPINKA | D-2240-0038-2 | - | - | 1 | 1 | 1 | 1 | 1 | 1 | 1 | 1 |
| 183 | PŁYTKA | D-2430-503-1 | - | - | 1 | 1 | 1 | 1 | 1 | 1 | 1 | 1 |
| 184 | KAPTUREK | D-2870-034-1 | - | - | 1 | 1 | 1 | 1 | 1 | 1 | 1 | 1 |
| 185 | PODKŁADKA | STALOWA 3-2 ZN | PN-78/W-82007 | 8832-910-210-180 | 4 | 4 | 4 | 4 | 4 | 4 | 4 | 4 |
| 186 | WKRĘT | DO PŁACH A 6B2,9X0,5 ZN | PN-79/W-83106 | - | 2 | 2 | 2 | 2 | 2 | 2 | 2 | 2 |
| 187 | WKRĘT | STALOWY M3X10-4,8-I ZN | PN-74/M-82227 | - | 2 | 2 | 2 | 2 | 2 | 2 | 2 | 2 |
| 188 | NAKRETKA | STALOWA M3-6-I ZN | PN-75/W-82144 | 0653-521-006-656 | 2 | 2 | 2 | 2 | 2 | 2 | 2 | 2 |
| 189 | DRUT | DCM 0,5 | UT-72/K-011 | - | 3,5 | 3,5 | 3,5 | 3,5 | 3,5 | 3,5 | 3,5 | 3,5 |
| 190 | PRZEWOD | OMYP 2X0,50 | PN-73/E-90103 | - | 60 | 60 | 60 | 60 | 60 | 60 | 60 | 60 |
| 191 | PRZEWOD | TLW 1X0,20 CZARNY | PN-74/T-90204 | - | 54 | 54 | 54 | 54 | 54 | 54 | 54 | 54 |
| 192 | PRZEWOD | TLW 1X0,20 ZIELONY | PN-74/T-90204 | - | 57 | 57 | 57 | 57 | 57 | 57 | 57 | 57 |
| 193 | PRZEWOD | TLW 1X0,20 NIEPIEFSKI | PN-74/T-90204 | - | 3,5 | 3,5 | 3,5 | 3,5 | 3,5 | 3,5 | 3,5 | 3,5 |
| 194 | PRZEWOD | TLW 3X0,20 | PN-74/T-90211 | - | 69 | 69 | 69 | 69 | 69 | 69 | 69 | 69 |
| 195 | PRZEWOD | TLW 4X0,20 | PN-74/T-90211 | - | 18 | 18 | 18 | 18 | 18 | 18 | 18 | 18 |
| 196 | PRZEWOD | TLW 6X0,20 | PN-74/T-90211 | - | 68 | 68 | 68 | 68 | 68 | 68 | 68 | 68 |
| 197 | PRZEWOD | TLW 8X0,20 | PN-74/T-90211 | - | 57 | 57 | 57 | 57 | 57 | 57 | 57 | 57 |
| 198 | PRZEWOD | PSL 300-0,9/7,4 | PN-64/T-90602 | - | 66 | 66 | 66 | 66 | 66 | 66 | 66 | 66 |
| 199 | WAZ | ELEKTROIZOLACYJNY Z PCW 1X0,5 | PN-67/T-89209 | - | 1 | 1 | 1 | 1 | 1 | 1 | 1 | 1 |
| 200 | WAZ | ELEKTROIZOLACYJNY Z PCW 2X0,5 | PN-67/T-89209 | - | 7 | 7 | 7 | 7 | 7 | 7 | 7 | 7 |
| ZFESCI ZESPOŁÓW KINESKOPU 9631-3000-5 I 9631-3000-6 | | | | | | | | | | | | |
| 201 | V351 | LAMPY KINESKOPOWA A1-140W | PN-74/3371-52 | 1155-314-300-116 | 1 | 1 | 1 | 1 | 1 | 1 | 1 | 1 |
| 202 | V351 | LAMPY KINESKOPOWA A50-140W | PN-74/3371-51 | 1155-315-300-110 | 1 | 1 | 1 | 1 | 1 | 1 | 1 | 1 |
| 203 | R815 | REZYSTOR 0W2-2A 1 W 4,7 MΩ 20% | WT-77/L7/072 | 1158-112-648-030 | 1 | 1 | 1 | 1 | 1 | 1 | 1 | 1 |
| 204 | C807 | KONDENSATOR KSF-041 4700PF 20% 2,5KV- | WT-72/T-KSF-041 | 1158-124-046-792 | 1 | 1 | 1 | 1 | 1 | 1 | 1 | 1 |
| 205 | L955 | ZESPOL CIEWEK ODCHYLACYJNYCH AS110S/623-2 | WT-75/WPM-14/ZPT-011 | 1158-821-350-028 | 1 | 1 | 1 | 1 | 1 | 1 | 1 | 1 |
| 206 | W6 | NASADKA N7-2 | WT74/923-085-091/242 | 1158-643-102-057 | 1 | 1 | 1 | 1 | 1 | 1 | 1 | 1 |
| 207 | KONCOWKA | LUTOWNICZA K11-11AG | ZN-70/WPM-14/T15-086 | 1158-620-700-078 | 1 | 1 | 1 | 1 | 1 | 1 | 1 | 1 |
| 208 | KONCOWKA | LUTOWNICZA K12-1 AG | ZN-70/WPM-14/T15-086 | 1158-620-700-078 | 2 | 2 | 2 | 2 | 2 | 2 | 2 | 2 |
| 209 | WIAZKA | PRZEWODÓW DO CIEWEK ODCH | 9625-4000-2 | - | 1 | 1 | 1 | 1 | 1 | 1 | 1 | 1 |
| 210 | SPRZĘT | YNNKA LUTOWNICZA SC3 | - | - | 1 | 1 | 1 | 1 | 1 | 1 | 1 | 1 |
| 211 | UKŁAD | ZAFZP KINESKOPU 9425-4000-3 | - | - | 5 | 5 | 5 | 5 | 5 | 5 | 5 | 5 |
| 212 | UKŁAD | ZAFZP KINESKOPU 9425-4000-4 | - | - | 1 | 1 | 1 | 1 | 1 | 1 | 1 | 1 |

| 1 | 2 | 3 | 4 | 5 | 6 | 7 | 8 | 9 | 10 | 11 | 12 | 13 |
|--|--|---------------------------------|-----------------|------------------|-----|---|---|---|----|---------|----|---------------|
| 213 | L957 | ROZEN WALCOWY RWO 6X1X12 F-1001 | L9/W-2343-0013 | 1158-415-416-100 | 1 | | | | | | | |
| 214 | KLIPS 7 C-2170-057-1 | | | 8832-910-210-883 | 1 | | | | | 6.00 | | N625 POLFER |
| 215 | PLYTKA D-2410-307-1 | | | 8832-910-473-309 | 1 | | | | | | | N625 UNIMOR |
| 216 | SPREZYNA D-2567-0010-1 | | | 8832-910-665-185 | 1 | | | | | | | N625 UNIMOR |
| 217 | LINKA LAGC 0,75 | | | - | 72 | | | | | | | N625 PROTUS |
| 218 | LINKA LAGC 0,75 | | | - | 117 | | | | | | | N625 |
| 219 | PRZEWOD TLWY 1X0,20 CZARNY | | | - | 11 | | | | | | | N625 |
| 220 | PRZEWOD TLWY 6X0,20 | | | - | 34 | | | | | | | N625 |
| 221 | LINKA SKALOWA J6/995/1 | | | - | 86 | | | | | | | N625 |
| 222 | LINKA SKALOWA J6/995/1 | | | - | 79 | | | | | | | |
| CZESCI CHASSIS ZLOZONEGO 9625-2000/A-3 | | | | | | | | | | | | |
| 223 | T952 | TRANZYSTOR RU 204 | | 1156-232-090-907 | 1 | | | | | | | N625 TOSHIBA |
| 224 | T954 | TRANZYSTOR RUX 86 | | - | 1 | | | | | | | N625 PHILLIPS |
| 225 | R904 | DIONA BIP 620 C 12 | WT-77/CEMI/A-26 | 1156-142-401-023 | 1 | | | | | 105.00 | | N625 CEMI |
| 226 | LISTA PRZEWODOW LP-0625-2100 ZAŁ 1 | | | 8832-910-290-889 | 1 | | | | | | | N625 TECHNOM |
| 227 | KONCOWKA LUTOWNICZA D-2761-0016-1 | | | 8832-910-210-282 | 2 | | | | | 6.00 | | N625 UNIMOR |
| 228 | MODUL SYNCHRONIZACJI MS-1001 9625-2500-1 | | | 8832-910-320-186 | 1 | | | | | 775.00 | | N625 MIFLEX |
| 229 | MODUL RAKKI MW-1002 9625-2400-1 | | | 8832-910-321-380 | 1 | | | | | 1000.00 | | N625 ESI |
| 230 | MODUL P CZ MP-1001 T4-a-4402-001-1 | | | 8832-918-320-441 | 1 | | | | | 1450.00 | | N625 MIFLEX |
| 231 | MODUL FONII MF-1002 T4-C-4492-007-1 | | | 8832-918-320-747 | 1 | | | | | 880.00 | | N625 MIFLEX |
| 232 | MODUL GŁOWICY MG-1001 9625-2200-1 | | | 8832-910-320-084 | 1 | | | | | 3100.00 | | N625 UNIMOR |
| 233 | RADIATOR ZŁOZONY 9625-2900-1 | | | - | 1 | | | | | | | N625 UNIMOR |
| 234 | RADIATOR ZŁOZONY 9625-2800-1 | | | - | 1 | | | | | | | N625 UNIMOR |
| 235 | PŁYTKA GŁOWNA 9625-2100/A-4 | | | - | 1 | | | | | | | N625 UNIMOR |
| 236 | PŁYTKA D-1641-005-2 | | | 8832-910-471-185 | 4 | | | | | 6.00 | | N625 UNIMOR |
| 237 | TULEJKA D-1830-128-1 | | | 8832-910-783-706 | 1 | | | | | 3.00 | | N625 UNIMOR |
| 238 | RADIATOR D-2160-065-1 | | | - | 1 | | | | | | | N625 UNIMOR |
| 239 | RADIATOR C-2160-066-1 | | | - | 1 | | | | | | | N625 UNIMOR |
| 240 | WSPORNIK UNIVERSALNY C-2170-077-1 | | | - | 1 | | | | | | | N625 UNIMOR |
| 241 | TULEJKA ŁĄCZACA C-2170-031/A-1 | | | - | 3 | | | | | | | N625 UNIMOR |
| 242 | IZOLATOR PRZEWODOW D-2170-032-1 | | | - | 4 | | | | | | | N625 UNIMOR |
| 243 | KLIPS KAPLA WN D-2170-033-1 | | | 8832-910-190-005 | 1 | | | | | | | N625 UNIMOR |
| 244 | PŁYTKA KAPLA WN D-2170-035-1 | | | 8832-910-216-104 | 1 | | | | | | | N625 UNIMOR |
| 245 | NOZKA CHASSIS PRAWA R-2170-036-1 | | | - | 1 | | | | | 45.00 | | N625 UNIMOR |
| 246 | WSPORNIK P CZ C-2170-040-1 | | | 8832-910-370-380 | 1 | | | | | | | N625 UNIMOR |
| 247 | PŁYTKA IZOLACYJNA TVL C-2170-041-1 | | | - | 1 | | | | | | | N625 UNIMOR |
| 248 | NOZKA CHASSIS LEWA C-2170-042-1 | | | - | 1 | | | | | 46.50 | | N625 UNIMOR |
| 249 | LISTWA CHASSIS C-2220-237-1 | | | 8832-910-370-289 | 1 | | | | | | | N625 UNIMOR |
| 250 | WSPORNIK GŁOWICY II D-2220-238-1 | | | - | 1 | | | | | | | N625 UNIMOR |
| 251 | WSPORNIK P CZ C-2220-239-1 | | | - | 1 | | | | | | | N625 UNIMOR |
| 252 | RAMA RADIATORA C-2220-240-1 | | | - | 1 | | | | | | | N625 UNIMOR |
| 253 | WSPORNIK GŁOWICY I D-2250-065-1 | | | - | 1 | | | | | | | N625 UNIMOR |
| 254 | WSPORNIK DIODY D-2410-253-1 | | | - | 1 | | | | | | | N625 UNIMOR |
| 255 | PŁYTKA USTALAJACA D-2410-260-1 | | | - | 3 | | | | | | | N625 UNIMOR |
| 256 | POKRYWA TVL C-2430-430-1 | | | - | 1 | | | | | | | N625 UNIMOR |
| 257 | CHASSIS H-2450-127-1 | | | - | 1 | | | | | | | N625 UNIMOR |
| 258 | PŁYTKA IZOLACYJNA D-2460-180-1 | | | 8832-910-473-706 | 1 | | | | | 1.50 | | N625 UNIMOR |
| 259 | PODKŁADKA D-2460-308-1 | | | - | 1 | | | | | | | N625 |
| 260 | PODKŁADKA STALOWA 3,2 ZN | | | - | 2 | | | | | | | N625 |
| 261 | PODKŁADKA STALOWA 4,3 ZN | | | - | 4 | | | | | | | N625 |
| 262 | PODKŁADKA STALOWA 4,3 ZN | | | - | 3 | | | | | | | N625 |
| 263 | PODKŁADKA STALOWA SPREZYSTA 3,1 ZN | | | - | 3 | | | | | | | N625 |
| 264 | WKRET DO BLACH A GR3, SX13 ZN | | | - | 4 | | | | | | | N625 |
| 265 | WKRET DO BLACH A GR3, 9X13 ZN | | | - | 2 | | | | | | | N625 |
| 266 | WKRET DO BLACH A GR3, 9X16 ZN | | | - | 4 | | | | | | | N625 |
| 267 | WKRET DO BLACH A GR3, 9X6,5 ZN | | | - | 10 | | | | | | | N625 |

| 1 | 2 | 3 | 4 | 5 | 6 | 7 | 8 | 9 | 10 | 11 | 12 | 13 |
|------------------------------------|-------------------------------|-------------|---------------------|------------------|---|-----|---|---|----|----|----|-------------------|
| 268 | WKRST STALOWY M3X5-4,8-1 ZN | | PN-74/W-82227 | - | - | 2 | | | | | | 1625 |
| 269 | WKRST STALOWY M3X10-4,8-1 ZN | | PN-74/W-82227 | - | - | 2 | | | | | | 1625 |
| 270 | WKRST STALOWY M3X12-4,8-1 ZN | | PN-74/W-82227 | - | - | 2 | | | | | | 1625 |
| 271 | NAKRETKA STALOWA M3-6-1 ZN | | PN-75/W-82144 | 0653-521-006-656 | - | 3 | | | | | | 1625 |
| 272 | PRZEWOD TLWY 3X0,20 | | PN-74/T-90211 | - | - | 6,5 | | | | | | 1625 |
| CZESCI PLATY GLOWNEJ 9625-2100/A-4 | | | | | | | | | | | | |
| 273 | U901 UKAD STALOWY UL 1500 L | | AN-81/3375-39,02 | 1156-313-101-005 | 1 | | | | | | | 78,00 1625 CEMI |
| 274 | T801 TRANZYSTOR RC 147 A | | AN-81/3375-30,05 | 1156-211-314-016 | 1 | | | | | | | 35,00 1625 CEMI |
| 275 | T802 TRANZYSTOR RC 157 A | | AN-81/3375-30,06 | 1156-211-311-026 | 1 | | | | | | | 37,00 1625 CEMI |
| 276 | T901 TRANZYSTOR RD 136 | | WT-80/CEMI/A-42 | 1156-221-304-000 | 1 | | | | | | | 40,00 1625 CEMI |
| 277 | T951 TRANZYSTOR RC 211 A GR1A | | AN-80/3375-30,03 | - | 1 | | | | | | | 145,00 1625 CEMI |
| 278 | T953 TRANZYSTOR RC 303 | | WT-80/CEMI/A-53 | 1156-223-425-008 | 1 | | | | | | | 105,00 1625 CEMI |
| 279 | D801 DIOA BAVP 18 | | AN-81/3375-29,02 | 1156-132-502-000 | 1 | | | | | | | 10,00 1625 CEMI |
| 280 | D901 DIOA BVP 401-1000 | | WT-79/CEMI/A-57 | 1156-112-203-065 | 1 | | | | | | | 25,00 1625 CEMI |
| 281 | D906 DIOA RZP 683 C 13 | | WT-77/CEMI/P12/A-02 | 1156-142-501-033 | 1 | | | | | | | 30,00 1625 CEMI |
| 282 | D951 DIOA KYX 30 | | TPTF-33-317/77 | - | 1 | | | | | | | 1625 TESLA |
| 283 | D952 DIOA BVP 401-400 | | WT-79/CEMI/A-57 | 1156-112-203-037 | 1 | | | | | | | 30,00 1625 CEMI |
| 284 | D953 DIOA E500 C5 | | WT-77/CEMI/P12/A-02 | - | 1 | | | | | | | 127,00 1625 RFT |
| 285 | D954 DIOA RZP 683 C 33 | | WT-79/CEMI/A-57 | 1156-142-501-122 | 1 | | | | | | | 30,00 1625 CEMI |
| 286 | D955 DIOA BVP 401-400 | | WT-79/CEMI/A-57 | 1156-112-203-037 | 1 | | | | | | | 30,00 1625 CEMI |
| 287 | D956 DIOA BA 157 | ONP BYF 404 | WT-82/CEMI/A-67 | 1156-112-205-000 | 1 | | | | | | | 35,00 1625 CEMI |
| 288 | D957 DIOA BA 157 | ONP BYF 404 | WT-82/CEMI/A-67 | 1156-112-205-000 | 1 | | | | | | | 35,00 1625 CEMI |
| 289 | D958 DIOA BAVP 17 | | AN-81/3375-29,02 | 1156-132-501-000 | 1 | | | | | | | 8,00 1625 CEMI |
| 290 | D959 DIOA BVP 401-400 | | WT-79/CEMI/A-57 | 1156-112-203-037 | 1 | | | | | | | 30,00 1625 CEMI |
| 291 | D960 DIOA BA 157 | | WT-82/CEMI/A-67 | 1156-112-206-001 | 1 | | | | | | | 40,00 1625 CEMI |
| 292 | R801 REZYSTOR OWZ-2A 0,25 W | 4,7 KΩ 5% | WT-77/L7/072 | 1158-112-640-305 | 1 | | | | | | | 4,00 1625 TELPOD |
| 293 | R802 REZYSTOR OWZ-2A 0,25 W | 4,7 KΩ 5% | WT-77/L7/072 | 1158-112-640-150 | 1 | | | | | | | 4,00 1625 TELPOD |
| 294 | R803 REZYSTOR OWZ-2A 0,25 W | 10 KΩ 5% | WT-77/L7/072 | 1158-112-640-237 | 1 | | | | | | | 4,00 1625 TELPOD |
| 295 | R804 REZYSTOR OWZ-2A 0,25 W | 10 KΩ 5% | WT-77/L7/072 | 1158-112-640-471 | 1 | | | | | | | 4,00 1625 TELPOD |
| 296 | R805 REZYSTOR OWZ-2A 0,5 W | 560 Ω 10% | WT-77/L7/072 | 1158-112-644-100 | 1 | | | | | | | 2,00 1625 TELPOD |
| 297 | R806 REZYSTOR OWZ-2A 0,25 W | 3,9 KΩ 5% | WT-77/L7/072 | 1158-112-640-135 | 1 | | | | | | | 4,00 1625 TELPOD |
| 298 | R807 REZYSTOR OWZ-2A 0,25 W | 3,3 KΩ 5% | WT-77/L7/072 | 1158-112-640-110 | 1 | | | | | | | 4,00 1625 TELPOD |
| 299 | R808 REZYSTOR OWZ-2A 0,25 W | 7,5 KΩ 5% | WT-77/L7/072 | 1158-112-640-209 | 1 | | | | | | | 4,00 1625 TELPOD |
| 300 | R809 REZYSTOR OWZ-2A 0,25 W | 5,6 KΩ 5% | WT-77/L7/072 | 1158-112-640-176 | 1 | | | | | | | 4,00 1625 TELPOD |
| 301 | R854 REZYSTOR OWZ-2A 0,25 W | 1,5 KΩ 5% | WT-77/L7/072 | 1158-112-640-033 | 1 | | | | | | | 4,00 1625 TELPOD |
| 302 | R855 REZYSTOR OWZ-2A 0,25 W | 330 Ω 5% | WT-77/L7/072 | 1158-112-639-866 | 1 | | | | | | | 4,00 1625 TELPOD |
| 303 | R856 REZYSTOR OWZ-2A 0,25 W | 470 KΩ 5% | WT-77/L7/072 | 1158-112-640-634 | 1 | | | | | | | 4,00 1625 TELPOD |
| 304 | R857 POTENCJOMETR TYP-114 | 4,7 KΩ | WT-73/L7/143 | 1158-115-011-089 | 1 | | | | | | | 8,00 1625 TELPOD |
| 305 | R901 REZYSTOR RA-50 | 6,8 KΩ 5% | WT-74/L7/126 | 1158-111-004-314 | 1 | | | | | | | 55,00 1625 TELPOD |
| 306 | R902 REZYSTOR RA-50 | 39 Ω 5% | WT-74/L7/126 | 1158-111-004-498 | 1 | | | | | | | 55,00 1625 TELPOD |
| 307 | R903 REZYSTOR RA-50 | 47 Ω 5% | WT-74/L7/126 | 1158-111-004-518 | 1 | | | | | | | 55,00 1625 TELPOD |
| 308 | R904 REZYSTOR PAC-50 W-1 | 6,8 KΩ 5% | WT-73/L7/230 | 1158-111-032-419 | 1 | | | | | | | 58,00 1625 TELPOD |
| 309 | R905 REZYSTOR OWZ-2A 2 W | 33 KΩ 5% | WT-77/L7/072 | 1158-112-649-352 | 1 | | | | | | | 7,00 1625 TELPOD |
| 310 | R906 REZYSTOR OWZ-2A 2 W | 270 Ω 5% | WT-77/L7/072 | 1158-112-648-850 | 1 | | | | | | | 7,00 1625 TELPOD |
| 311 | R907 REZYSTOR OWZ-2A 0,5 W | 10 Ω 10% | WT-77/L7/072 | 1158-112-643-897 | 1 | | | | | | | 2,00 1625 TELPOD |
| 312 | R908 REZYSTOR OWZ-2A 0,5 W | 10 Ω 10% | WT-77/L7/072 | 1158-112-643-897 | 1 | | | | | | | 2,00 1625 TELPOD |
| 313 | R909 REZYSTOR RDCO 8 W | 22 Ω 10% | WT-73/L7/145 | 1158-111-057-114 | 1 | | | | | | | 32,00 1625 TELPOD |
| 314 | R910 REZYSTOR RDCO 5 W | 47 Ω 5% | WT-73/L7/145 | 1158-111-055-418 | 1 | | | | | | | 30,00 1625 TELPOD |
| 315 | R912 REZYSTOR RDCO 5 W | 620 Ω 5% | WT-73/L7/145 | 1158-111-055-680 | 1 | | | | | | | 30,00 1625 TELPOD |
| 316 | R951 REZYSTOR RA-50 | 68 Ω 5% | WT-74/L7/126 | 1158-111-004-550 | 1 | | | | | | | 55,00 1625 TELPOD |
| 317 | R952 REZYSTOR OWZ-2A 0,5 W | 270 Ω 5% | WT-77/L7/072 | 1158-112-642-855 | 1 | | | | | | | 4,00 1625 TELPOD |
| 318 | R953 REZYSTOR OWZ-2A 0,25 W | 1 KΩ 5% | WT-77/L7/072 | 1158-112-639-006 | 1 | | | | | | | 5,00 1625 TELPOD |
| 319 | R954 REZYSTOR MLT 0,5 W | 82 Ω 5% | AN-78/3281-36 | 1158-112-701-005 | 1 | | | | | | | 6,00 1625 TELPOD |
| 320 | R956 REZYSTOR OWZ-2A 1 W | 1 MΩ 10% | WT-77/L7/072 | 1158-112-647-567 | 1 | | | | | | | 4,00 1625 TELPOD |
| 321 | R957 REZYSTOR MLT 1 W | 47 KΩ 5% | AN-78/3281-36 | 1158-112-711-946 | 1 | | | | | | | 6,00 1625 TELPOD |
| 322 | R958 POTENCJOMETR TYP-114 | 10 KΩ | WT-73/L7/143 | 1158-115-011-091 | 1 | | | | | | | 8,00 1625 TELPOD |

| 1 | 1 | 2 | 3 | 4 | 5 | 6 | 7 | 8 | 9 | 10 | 11 | 12 | 13 |
|-----|------|-------------|------------|------------------|--------|-----|--------------------|------------------|---|----|--------|------|---------|
| 323 | R959 | REZYSTOR | 04Z-2A | 0,25 W | 10 KΩ | 5% | WT-77/L7/072 | 1158-112-640-237 | 1 | 1 | 4.00 | N625 | TELPOD |
| 324 | R960 | REZYSTOR | 04Z-2A | 1 W | 33 KΩ | 5% | AN-78/3281-36 | 1158-112-711-905 | 1 | 1 | 55.00 | N625 | TELPOD |
| 325 | R961 | REZYSTOR | 04Z-2A | 0,25 W | 51 Ω | 5% | WT-74/L7/126 | 1158-111-004-520 | 1 | 1 | 4.00 | N625 | TELPOD |
| 326 | R962 | REZYSTOR | 04Z-2A | 0,5 W | 1,5 KΩ | 5% | WT-77/L7/072 | 1158-112-640-033 | 1 | 1 | 4.00 | N625 | TELPOD |
| 327 | R963 | REZYSTOR | 04Z-2A | 0,5 W | 5,6 KΩ | 5% | WT-77/L7/072 | 1158-112-643-179 | 1 | 1 | 4.00 | N625 | TELPOD |
| 328 | R964 | REZYSTOR | 04Z-2A | 0,5 W | 22 Ω | 10% | WT-77/L7/072 | 1158-112-643-932 | 1 | 1 | 2.00 | N625 | TELPOD |
| 329 | R965 | REZYSTOR | 04Z-2A | 0,5 W | 8,2 Ω | 10% | WT-73/L7/145 | 1158-111-055-856 | 1 | 1 | 28.00 | N625 | TELPOD |
| 330 | R966 | REZYSTOR | 04Z-2A | 0,25 W | 100 KΩ | 5% | WT-77/L7/072 | 1158-112-640-471 | 1 | 1 | 4.00 | N625 | TELPOD |
| 331 | R967 | REZYSTOR | 04Z-2A | 0,25 W | 3,3 KΩ | 5% | WT-77/L7/072 | 1158-112-640-110 | 1 | 1 | 4.00 | N625 | TELPOD |
| 332 | R968 | REZYSTOR | 04Z-2A | 0,5 W | 1 KΩ | 10% | WT-77/L7/072 | 1158-112-644-139 | 1 | 1 | 2.00 | N625 | TELPOD |
| 333 | R969 | REZYSTOR | 04Z-2A | 0,5 W | 10 Ω | 10% | WT-77/L7/072 | 1158-112-643-897 | 1 | 1 | 2.00 | N625 | TELPOD |
| 334 | R970 | REZYSTOR | 04Z-2A | 0,5 W | 3,3 Ω | 5% | WT-73/L7/145 | 1158-111-055-138 | 1 | 1 | 30.00 | N625 | TELPOD |
| 335 | R971 | REZYSTOR | 04Z-2A | 0,5 W | 240 Ω | 5% | WT-74/L7/126 | 1158-111-005-740 | 2 | 1 | 45.00 | N625 | TELPOD |
| 336 | R972 | REZYSTOR | 04Z-2A | 0,5 W | 47 KΩ | 5% | WT-77/L7/072 | 1158-112-643-348 | 1 | 1 | 4.00 | N625 | TELPOD |
| 337 | R973 | REZYSTOR | 04Z-2A | 0,25 W | 10 KΩ | 5% | WT-77/L7/072 | 1158-112-640-237 | 1 | 1 | 4.00 | N625 | TELPOD |
| 338 | R974 | REZYSTOR | 04Z-2A | 0,5 W | 3,3 Ω | 5% | WT-79/L7/215 | 1158-112-817-541 | 1 | 1 | 4.00 | N625 | TELPOD |
| 339 | R975 | REZYSTOR | 04Z-2A | 0,125 W | 22 KΩ | 20% | WT-77/L7/072 | 1158-112-638-707 | 1 | 1 | 2.00 | N625 | TELPOD |
| 340 | C801 | KONDENSATOR | 02/E TYP 2 | 2,2 UF | 63 V | | AN-77/3281-38 | 1158-127-024-622 | 1 | 1 | 21.00 | N625 | ELWA |
| 341 | C802 | KONDENSATOR | 02/E TYP 2 | 220 NF | 10V | | 2N-81/PM-14/L15-02 | 1158-124-625-030 | 1 | 1 | 25.00 | N625 | MIFLEX |
| 342 | C806 | KONDENSATOR | 04/U TYP 2 | 1000 UF | 25 V | | AN-77/3281-38 | 1158-127-052-905 | 1 | 1 | 40.00 | N625 | ELWA |
| 343 | C901 | KONDENSATOR | 04/U TYP 2 | 1000 UF | 25 V | | WT-70/1-KSF-020 | - | 1 | 1 | 6.00 | N625 | PLESSEY |
| 344 | C902 | KONDENSATOR | 04/U TYP 2 | 1000 UF | 100V | | AN-77/3281-38 | 1158-127-217-840 | 1 | 1 | 310.00 | N625 | ELWA |
| 345 | C903 | KONDENSATOR | 04/U TYP 2 | 25+75+200+200 UF | 350 V | | AN-77/3281-38 | 1158-127-053-707 | 1 | 1 | 18.00 | N625 | ELWA |
| 346 | C904 | KONDENSATOR | 04/U TYP 2 | 100 UF | 40 V | | AN-78/3281-25 | 1158-135-927-213 | 1 | 1 | 10.00 | N625 | CERAD |
| 347 | C905 | KONDENSATOR | 04/U TYP 2 | 100 UF | 40 V | | 2N-81/PM-14/L15-02 | 1158-124-625-233 | 1 | 1 | 25.00 | N625 | MIFLEX |
| 348 | C906 | KONDENSATOR | 04/U TYP 2 | 220 NF | 20V | | 2N-81/PM-14/L15-02 | 1158-124-625-233 | 1 | 1 | 25.00 | N625 | MIFLEX |
| 349 | C907 | KONDENSATOR | 04/U TYP 2 | 220 NF | 20V | | AN-77/3281-38 | 1158-127-051-802 | 1 | 1 | 33.00 | N625 | ELWA |
| 350 | C908 | KONDENSATOR | 04/U TYP 2 | 1000 UF | 16 V | | AN-77/3281-38 | 1158-127-051-795 | 1 | 1 | 18.00 | N625 | ELWA |
| 351 | C909 | KONDENSATOR | 04/U TYP 2 | 470 UF | 16 V | | AN-77/3281-38 | 1158-127-051-680 | 1 | 1 | 14.00 | N625 | ELWA |
| 352 | C910 | KONDENSATOR | 04/U TYP 2 | 47 UF | 16 V | | 2N-81/PM-14/L15-02 | 1158-124-625-220 | 1 | 1 | 11.00 | N625 | MIFLEX |
| 353 | C911 | KONDENSATOR | 04/U TYP 2 | 150 NF | 20V | | AN-77/3281-38 | 1158-127-051-680 | 1 | 1 | 14.00 | N625 | ELWA |
| 354 | C912 | KONDENSATOR | 04/U TYP 2 | 47 UF | 16 V | | AN-77/3281-38 | 1158-127-051-680 | 1 | 1 | 21.00 | N625 | ELWA |
| 355 | C952 | KONDENSATOR | 02/E TYP 2 | 4,7 UF | 63 V | | AN-77/3281-38 | 1158-127-024-648 | 1 | 1 | 11.00 | N625 | MIFLEX |
| 356 | C953 | KONDENSATOR | 02/E TYP 2 | 22 NF | 10V | | 2N-81/PM-14/L15-02 | 1158-124-626-030 | 1 | 1 | 36.00 | N625 | MIFLEX |
| 357 | C955 | KONDENSATOR | 02/E TYP 2 | 22 NF | 10V | | WT-76/1-KFVP-010 | 1158-124-750-011 | 1 | 1 | 12.00 | N625 | MIFLEX |
| 358 | C956 | KONDENSATOR | 02/E TYP 2 | 22 NF | 10V | | WT-68/1-MKSE-012 | 1158-124-626-030 | 1 | 1 | 18.00 | N625 | CERAD |
| 359 | C957 | KONDENSATOR | 02/E TYP 2 | 22 NF | 10V | | 2N-81/PM-14/L15-02 | 1158-135-787-055 | 1 | 1 | 8.00 | N625 | CERAD |
| 360 | C958 | KONDENSATOR | 02/E TYP 2 | 22 NF | 10V | | AN-78/3281-25 | 1158-135-902-711 | 1 | 1 | 26.00 | N625 | ELWA |
| 361 | C959 | KONDENSATOR | 02/E TYP 2 | 22 NF | 10V | | AN-77/3281-38 | 1158-127-053-804 | 1 | 1 | 38.00 | N625 | ELWA |
| 362 | C960 | KONDENSATOR | 02/E TYP 2 | 22 NF | 10V | | AN-78/3281-25 | 1158-135-787-055 | 1 | 1 | 18.00 | N625 | CERAD |
| 363 | C961 | KONDENSATOR | 02/E TYP 2 | 22 NF | 10V | | AN-77/3281-38 | 1158-127-056-340 | 1 | 1 | 15.00 | N625 | CERAD |
| 364 | C962 | KONDENSATOR | 02/E TYP 2 | 22 NF | 10V | | AN-78/3281-25 | 1158-135-945-131 | 1 | 1 | 18.00 | N625 | ELWA |
| 365 | C963 | KONDENSATOR | 02/E TYP 2 | 22 NF | 10V | | AN-77/3281-38 | 1158-127-053-784 | 1 | 1 | 45.00 | N625 | ELWA |
| 366 | C964 | KONDENSATOR | 02/E TYP 2 | 22 NF | 10V | | AN-78/3281-25 | 1158-146-906-400 | 1 | 1 | 60.00 | N625 | ELWA |
| 367 | C965 | KONDENSATOR | 02/E TYP 2 | 22 NF | 10V | | AN-77/3281-38 | 1158-145-807-009 | 1 | 1 | 575.00 | N625 | ELWA |
| 368 | C966 | KONDENSATOR | 02/E TYP 2 | 22 NF | 10V | | AN-78/3281-25 | 1158-145-807-009 | 1 | 1 | 575.00 | N625 | ELWA |
| 369 | C967 | KONDENSATOR | 02/E TYP 2 | 22 NF | 10V | | AN-77/3281-38 | 1158-145-807-009 | 1 | 1 | 575.00 | N625 | ELWA |
| 370 | C968 | KONDENSATOR | 02/E TYP 2 | 22 NF | 10V | | AN-78/3281-25 | 1158-145-807-009 | 1 | 1 | 575.00 | N625 | ELWA |
| 371 | C969 | KONDENSATOR | 02/E TYP 2 | 22 NF | 10V | | AN-77/3281-38 | 1158-145-807-009 | 1 | 1 | 575.00 | N625 | ELWA |
| 372 | C970 | KONDENSATOR | 02/E TYP 2 | 22 NF | 10V | | AN-78/3281-25 | 1158-145-807-009 | 1 | 1 | 575.00 | N625 | ELWA |
| 373 | C971 | KONDENSATOR | 02/E TYP 2 | 22 NF | 10V | | AN-77/3281-38 | 1158-145-807-009 | 1 | 1 | 575.00 | N625 | ELWA |
| 374 | C972 | KONDENSATOR | 02/E TYP 2 | 22 NF | 10V | | AN-78/3281-25 | 1158-145-807-009 | 1 | 1 | 575.00 | N625 | ELWA |
| 375 | C973 | KONDENSATOR | 02/E TYP 2 | 22 NF | 10V | | AN-77/3281-38 | 1158-145-807-009 | 1 | 1 | 575.00 | N625 | ELWA |
| 376 | C974 | KONDENSATOR | 02/E TYP 2 | 22 NF | 10V | | AN-78/3281-25 | 1158-145-807-009 | 1 | 1 | 575.00 | N625 | ELWA |
| 377 | C975 | KONDENSATOR | 02/E TYP 2 | 22 NF | 10V | | AN-77/3281-38 | 1158-145-807-009 | 1 | 1 | 575.00 | N625 | ELWA |
| 378 | C976 | KONDENSATOR | 02/E TYP 2 | 22 NF | 10V | | AN-78/3281-25 | 1158-145-807-009 | 1 | 1 | 575.00 | N625 | ELWA |
| 379 | C977 | KONDENSATOR | 02/E TYP 2 | 22 NF | 10V | | AN-77/3281-38 | 1158-145-807-009 | 1 | 1 | 575.00 | N625 | ELWA |

LISTA PRZEKŁADÓW LP-0625-2100 ZAŁ. 2

| 1 | 2 | 3 | 4 | 5 | 6 | 7 | 8 | 9 | 10 | 11 | 12 | 13 |
|-----|-----|-----|-----|-----|------|-----|-----|-----|-----|-----|-----|-----|
| 380 | 381 | 382 | 383 | 384 | 385 | 386 | 387 | 388 | 389 | 390 | 391 | 392 |
| 393 | 394 | 395 | 396 | 397 | 398 | 399 | 400 | | | | | |
| 401 | 402 | 403 | 404 | 405 | 406 | 407 | 408 | 409 | 410 | 411 | 412 | 413 |
| 414 | | | | | | | | | | | | |
| 415 | 416 | 417 | 418 | 419 | 420 | 421 | 422 | 423 | 424 | 425 | 426 | 427 |
| 428 | 429 | 430 | 431 | 432 | | | | | | | | |
| 433 | | | | | | | | | | | | |
| 434 | 435 | | | | | | | | | | | |
| 436 | 437 | 438 | 439 | 440 | 441 | 442 | 443 | 444 | 445 | 446 | 447 | 448 |
| 449 | 450 | 451 | 452 | 453 | 454 | 455 | 456 | 457 | 458 | 459 | 460 | 461 |
| 462 | 463 | 464 | 465 | 466 | 467 | 468 | 469 | 470 | 471 | 472 | 473 | 474 |
| 475 | 476 | 477 | 478 | 479 | 480 | 481 | 482 | 483 | 484 | 485 | 486 | 487 |
| 488 | 489 | 490 | 491 | 492 | 493 | 494 | 495 | 496 | 497 | 498 | 499 | 500 |
| 501 | 502 | 503 | 504 | 505 | 506 | 507 | 508 | 509 | 510 | 511 | 512 | 513 |
| 514 | 515 | 516 | 517 | 518 | 519 | 520 | 521 | 522 | 523 | 524 | 525 | 526 |
| 527 | 528 | 529 | 530 | 531 | 532 | 533 | 534 | 535 | 536 | 537 | 538 | 539 |
| 540 | 541 | 542 | 543 | 544 | 545 | 546 | 547 | 548 | 549 | 550 | 551 | 552 |
| 553 | 554 | 555 | 556 | 557 | 558 | 559 | 560 | 561 | 562 | 563 | 564 | 565 |
| 566 | 567 | 568 | 569 | 570 | 571 | 572 | 573 | 574 | 575 | 576 | 577 | 578 |
| 579 | 580 | 581 | 582 | 583 | 584 | 585 | 586 | 587 | 588 | 589 | 590 | 591 |
| 592 | 593 | 594 | 595 | 596 | 597 | 598 | 599 | 600 | 601 | 602 | 603 | 604 |
| 605 | 606 | 607 | 608 | 609 | 610 | 611 | 612 | 613 | 614 | 615 | 616 | 617 |
| 618 | 619 | 620 | 621 | 622 | 623 | 624 | 625 | 626 | 627 | 628 | 629 | 630 |
| 631 | 632 | 633 | 634 | 635 | 636 | 637 | 638 | 639 | 640 | 641 | 642 | 643 |
| 644 | 645 | 646 | 647 | 648 | 649 | 650 | 651 | 652 | 653 | 654 | 655 | 656 |
| 657 | 658 | 659 | 660 | 661 | 662 | 663 | 664 | 665 | 666 | 667 | 668 | 669 |
| 670 | 671 | 672 | 673 | 674 | 675 | 676 | 677 | 678 | 679 | 680 | 681 | 682 |
| 683 | 684 | 685 | 686 | 687 | 688 | 689 | 690 | 691 | 692 | 693 | 694 | 695 |
| 696 | 697 | 698 | 699 | 700 | 701 | 702 | 703 | 704 | 705 | 706 | 707 | 708 |
| 709 | 710 | 711 | 712 | 713 | 714 | 715 | 716 | 717 | 718 | 719 | 720 | 721 |
| 722 | 723 | 724 | 725 | 726 | 727 | 728 | 729 | 730 | 731 | 732 | 733 | 734 |
| 735 | 736 | 737 | 738 | 739 | 740 | 741 | 742 | 743 | 744 | 745 | 746 | 747 |
| 748 | 749 | 750 | 751 | 752 | 753 | 754 | 755 | 756 | 757 | 758 | 759 | 760 |
| 761 | 762 | 763 | 764 | 765 | 766 | 767 | 768 | 769 | 770 | 771 | 772 | 773 |
| 774 | 775 | 776 | 777 | 778 | 779 | 780 | 781 | 782 | 783 | 784 | 785 | 786 |
| 787 | 788 | 789 | 790 | 791 | 792 | 793 | 794 | 795 | 796 | 797 | 798 | 799 |
| 800 | 801 | 802 | 803 | 804 | 805 | 806 | 807 | 808 | 809 | 810 | 811 | 812 |
| 813 | 814 | 815 | 816 | 817 | 818 | 819 | 820 | 821 | 822 | 823 | 824 | 825 |
| 826 | 827 | 828 | 829 | 830 | 831 | 832 | 833 | 834 | 835 | 836 | 837 | 838 |
| 839 | 840 | 841 | 842 | 843 | 844 | 845 | 846 | 847 | 848 | 849 | 850 | 851 |
| 852 | 853 | 854 | 855 | 856 | 857 | 858 | 859 | 860 | 861 | 862 | 863 | 864 |
| 865 | 866 | 867 | 868 | 869 | 870 | 871 | 872 | 873 | 874 | 875 | 876 | 877 |
| 878 | 879 | 880 | 881 | 882 | 883 | 884 | 885 | 886 | 887 | 888 | 889 | 890 |
| 891 | 892 | 893 | 894 | 895 | 896 | 897 | 898 | 899 | 900 | 901 | 902 | 903 |
| 904 | 905 | 906 | 907 | 908 | 909 | 910 | 911 | 912 | 913 | 914 | 915 | 916 |
| 917 | 918 | 919 | 920 | 921 | 922 | 923 | 924 | 925 | 926 | 927 | 928 | 929 |
| 930 | 931 | 932 | 933 | 934 | 935 | 936 | 937 | 938 | 939 | 940 | 941 | 942 |
| 943 | 944 | 945 | 946 | 947 | 948 | 949 | 950 | 951 | 952 | 953 | 954 | 955 |
| 956 | 957 | 958 | 959 | 960 | 961 | 962 | 963 | 964 | 965 | 966 | 967 | 968 |
| 969 | 970 | 971 | 972 | 973 | 974 | 975 | 976 | 977 | 978 | 979 | 980 | 981 |
| 982 | 983 | 984 | 985 | 986 | 987 | 988 | 989 | 990 | 991 | 992 | 993 | 994 |
| 995 | 996 | 997 | 998 | 999 | 1000 | | | | | | | |

| 1 | 2 | 3 | 4 | 5 | 6 | 7 | 8 | 9 | 10 | 11 | 12 | 13 |
|-----|-------|--------------|----------------------------|--------------------|----------|------------|----------------------|------------------|----|-------|------|---------|
| 433 | R116 | REZYSTOR | OWZ-2A | 0,125 W | 1 KOM | 5X | WT-77/L7/072 | 1158-112-637-161 | 1 | 4.00 | N625 | TELP0D |
| 434 | R117 | POTENCJOMETR | TVP-114 | 4,7 KΩ | 1 KOM | 5X | WT-73/L7/143 | 1158-115-011-089 | 1 | 8.00 | N625 | TELP0D |
| 435 | R118 | REZYSTOR | OWZ-2A | 0,125 W | 270 Ω | OM | WT-77/L7/072 | 1158-112-637-029 | 1 | 4.00 | N625 | TELP0D |
| 436 | R119 | REZYSTOR | OWZ-2A | 0,125 W | 270 Ω | OM | WT-77/L7/072 | 1158-112-637-029 | 1 | 4.00 | N625 | TELP0D |
| 437 | R120 | REZYSTOR | OWZ-2A | 0,125 W | 1 KOM | 5X | WT-77/L7/072 | 1158-112-637-161 | 1 | 4.00 | N625 | TELP0D |
| 438 | R121 | REZYSTOR | OWZ-2A | 0,125 W | 3,3 KOM | 5X | WT-77/L7/072 | 1158-112-637-289 | 1 | 4.00 | N625 | TELP0D |
| 439 | C101 | KONDENSATOR | EDRU | N150 1A | 6,8 PF | 0,25PF50 V | | | 1 | | N625 | TFK |
| 440 | C102 | KONDENSATOR | EDRU | N150 1A | 47 PF | 2X 50 V | | | 1 | | N625 | TFK |
| 441 | C103 | KONDENSATOR | EDRU | N150 1A | 6,8 PF | 2X 50 V | | | 1 | | N625 | TFK |
| 442 | C104 | KONDENSATOR | KPPF-2E-6-4N7-S-25-658 | | | | RN-78/3281-26 | | 1 | 10.00 | N625 | CERAD |
| 443 | C105 | KONDENSATOR | KPPF-2E-6-4N7-S-25-658 | | | | RN-78/3281-26 | | 1 | 10.00 | N625 | CERAD |
| 444 | C106 | KONDENSATOR | EDRU | N150 1A | 82 PF | 2X 50 V | | | 1 | | N625 | TFK |
| 445 | C107 | KONDENSATOR | EDRU | N750 1P | 330 PF | 2X 50 V | | | 1 | | N625 | TFK |
| 446 | C108 | KONDENSATOR | EDRU | N150 1A | 6,8 PF | 2X 50 V | | | 1 | | N625 | TFK |
| 447 | C109 | KONDENSATOR | EDRU | N150 1A | 12 PF | 2X 50 V | | | 1 | | N625 | TFK |
| 448 | C110 | KONDENSATOR | EDRU | N150 1A | 47 PF | 2X 50 V | | | 1 | | N625 | TFK |
| 449 | C111 | KONDENSATOR | EDRU | N150 1A | 15 PF | 2X 50 V | | | 1 | | N625 | TFK |
| 450 | C112 | KONDENSATOR | EDRU | N150 1A | 91 PF | 2X 50 V | | | 1 | | N625 | TFK |
| 451 | C113 | KONDENSATOR | EDRU | N150 1A | 3,3 PF | 2X 50 V | | | 1 | | N625 | TFK |
| 452 | C114 | KONDENSATOR | EDRU | N150 1A | 2,2 PF | 2X 50 V | | | 1 | | N625 | TFK |
| 453 | C115 | KONDENSATOR | EDRU | N150 1A | 6,2 PF | 2X 50 V | | | 1 | | N625 | TFK |
| 454 | C116 | KONDENSATOR | EDRU | N150 1A | 5,6 PF | 2X 50 V | | | 1 | | N625 | TFK |
| 455 | C117 | KONDENSATOR | KPPF-2F-12X12-27N-Z-25-668 | | | | RN-78/3281-26 | 1158-136-094-092 | 1 | 10.00 | N625 | CERAD |
| 456 | C118 | KONDENSATOR | KPPF-2E-6-4N7-S-25-658 | | | | RN-78/3281-26 | | 1 | 10.00 | N625 | CERAD |
| 457 | C119 | KONDENSATOR | KPPF-2E-6-4N7-S-25-658 | | | | RN-78/3281-26 | | 1 | 10.00 | N625 | CERAD |
| 458 | C120 | KONDENSATOR | 04/U TYP 2 | 10 UF | 16 V | | RN-77/3281-38 | 1158-127-051-609 | 1 | 13.00 | N625 | ELWA |
| 459 | C121 | KONDENSATOR | EDRU | N150 1A | 27 PF | 2X 50 V | | | 1 | | N625 | TFK |
| 460 | C122 | KONDENSATOR | 04/U TYP 2 | 10 UF | 16 V | | RN-77/3281-38 | 1158-127-051-609 | 1 | 13.00 | N625 | ELWA |
| 461 | C123 | KONDENSATOR | KPPF-2E-6-4N7-S-25-658 | | | | RN-78/3281-26 | | 1 | 10.00 | N625 | CERAD |
| 462 | C124 | KONDENSATOR | KPPF-2E-6-4N7-S-25-658 | | | | RN-78/3281-26 | | 1 | 10.00 | N625 | CERAD |
| 463 | C125 | KONDENSATOR | 04/U TYP 2 | 10 UF | 63 V | | RN-77/3281-38 | 1158-127-054-655 | 1 | 14.00 | N625 | ELWA |
| 464 | C126 | KONDENSATOR | EDRU | N150 1P | 150 PF | 5X 50 V | | | 1 | | N625 | TFK |
| 465 | C127 | KONDENSATOR | MKSE-01-02 | 100NF | 10X 100V | | WT-76/2-MKSE-018 | 1158-124-622-139 | 1 | 11.00 | N625 | MIFLEX |
| 466 | C128 | KONDENSATOR | EDRU | N150 1A | 62 PF | 2X 50 V | | | 1 | | N625 | TFK |
| 467 | C129 | KONDENSATOR | EDRU | N150 1A | 6,8 PF | 0,25PF50 V | | | 1 | | N625 | TFK |
| 468 | C130 | KONDENSATOR | KPPF-2E-6-1N0-S-25-658 | | | | RN-78/3281-26 | 1158-136-094-576 | 1 | 10.00 | N625 | CERAD |
| 469 | C131 | KONDENSATOR | KPPF-2F-12X12-47N-Z-25-668 | | | | RN-77/3281-38 | 1158-127-051-609 | 1 | 13.00 | N625 | ELWA |
| 470 | C132 | KONDENSATOR | 04/U TYP 2 | 10 UF | 16 V | | WT-75/MPM-14/7PT-002 | | 1 | | N625 | ELWA |
| 471 | L108 | CEWKA | KOREKCYJNA P 62 | | | | L9/1-4-391-1043 | 1158-146-850-305 | 1 | 25.00 | N625 | RIAZET |
| 472 | L110 | CEWKA | 7X7 503 668 | | | | L9/1-4-391-1043 | 1158-146-842-400 | 1 | 25.00 | N625 | POLFER |
| 473 | L112 | CEWKA | 7X7 424 668 | | | | L9/1-4-391-1043 | 1158-145-310-208 | 1 | 11.00 | N625 | POLFER |
| 474 | L109 | DIADZIK | W CZ 30 UH | DN-328-302 | | | L9/1-4-391-1043 | 1158-145-310-106 | 1 | 11.00 | N625 | POLFER |
| 475 | L101 | DIADZIK | W CZ 27 UH | DN-328-272 | | | ZN-78/MPM-14/T15-132 | 1158-142-855-220 | 1 | | N625 | ELTRA |
| 476 | PG101 | DIADZIE | MODULOWE MG-14 | | | | | | 1 | | N625 | MIFLEX |
| 477 | Z101 | ZWIERACZ | T4-D-2216-194-3 | | | | | | 1 | | N625 | MIFLEX |
| 478 | Z102 | ZWIERACZ | T4-D-2216-194-3 | | | | | | 1 | | N625 | MIFLEX |
| 479 | Z103 | ZWIERACZ | T4-D-2216-194-6 | | | | | | 1 | | N625 | MIFLEX |
| 480 | Z104 | ZWIERACZ | T4-D-2216-194-2 | | | | | | 1 | | N625 | MIFLEX |
| 481 | Z105 | ZWIERACZ | T4-D-2216-194-5 | | | | | | 1 | | N625 | MIFLEX |
| 482 | Z106 | ZWIERACZ | T4-D-2216-194-3 | | | | | | 1 | | N625 | MIFLEX |
| 483 | Z107 | ZWIERACZ | T4-D-2216-194-2 | | | | | | 1 | | N625 | MIFLEX |
| 484 | Z108 | ZWIERACZ | T4-D-2216-194-4 | | | | | | 1 | | N625 | MIFLEX |
| 485 | Z109 | ZWIERACZ | T4-D-2216-194-1 | | | | | | 1 | | N625 | MIFLEX |
| 486 | Z110 | ZWIERACZ | T4-D-2216-194-5 | | | | | | 1 | | N625 | MIFLEX |
| 487 | | PIYTKA | OPR0DU DUKOWANEGO | T4-R-2217-211A | | | RN-75/331P-01 | | 1 | | N625 | TORAL |
| 488 | | ROZEN | GWINTOWANY | PGMR 4X0,5X13 U-31 | | | L9/1-4-391-1006 | | 1 | | N625 | POLFER |
| 489 | | KOLEK | KONTAKTOWY | JENOSTRONNY 04 AG | | | ZN-79/MPM-14/UN1-006 | 8832-910-215-195 | 6 | 6.00 | N625 | UNITECH |

| 1 | 2 | 3 | 4 | 5 | 6 | 7 | 8 | 9 | 10 | 11 | 12 | 13 |
|-----|-------|--------------------------------------|-------------|-------|----------------------|------------------|-----|-------|------|---------|----|----|
| 543 | C251 | KONDENSATOR MKSF-20 | 150NF 20% | 100V- | ZN-81/MPM-14/L15-02 | 1158-124-625-220 | 1 | 11.00 | 6625 | WIFLEX | | |
| 544 | C252 | KONDENSATOR KEP-2E-10-6M8-S-140-658 | | | BN-78/3281-25 | 1158-135-983-733 | 1 | 10.00 | 6625 | CERD | | |
| 545 | C253 | KONDENSATOR MKSE-20 | 100NF 10% | 100V- | ZN-81/MPM-14/L15-02 | 1158-124-625-014 | 1 | 11.00 | 6625 | WIFLEX | | |
| 546 | C254 | KONDENSATOR 04/U TYP 2 | 47 UF 16 V | | BN-77/3281-38 | 1158-127-051-630 | 1 | 14.00 | 6625 | ELWA | | |
| 547 | C255 | KONDENSATOR MKSF-20 | 100NF 10% | 100V- | ZN-81/MPM-14/L15-02 | 1158-124-625-014 | 1 | 11.00 | 6625 | WIFLEX | | |
| 548 | C256 | KONDENSATOR KSF-022 | 10000PF 2% | 63V- | WT-71/1-KSF-022 | 1158-124-348-154 | 1 | 20.00 | 6625 | WIFLEX | | |
| 549 | C257 | KONDENSATOR KEP-2E-S-1N0-S-250-658 | | | BN-78/3281-25 | 1158-135-903-213 | 1 | 8.00 | 6625 | CERD | | |
| 550 | C258 | KONDENSATOR 04/U TYP 2 | 470 UF 25 V | | BN-77/3281-38 | 1158-127-052-885 | 1 | 22.00 | 6625 | ELWA | | |
| 551 | C259 | KONDENSATOR MKSF-20 | 1UF 20% | 100V- | ZN-81/MPM-14/L15-02 | 1158-124-625-274 | 1 | 25.00 | 6625 | WIFLEX | | |
| 552 | C260 | KONDENSATOR 04/U TYP 2 | 2,2 UF 40 V | | BN-77/3281-38 | 1158-127-053-728 | 1 | 14.00 | 6625 | ELWA | | |
| 553 | C261 | KONDENSATOR MKSE-20 | 100NF 10% | 100V- | ZN-81/MPM-14/L15-02 | 1158-124-625-014 | 1 | 11.00 | 6625 | WIFLEX | | |
| 554 | P6251 | ZŁĄCZE MODUŁOWE MG-R | | | ZN-78/MPM-14/L15-132 | 1158-642-855-103 | 1 | | 6625 | ELTA | | |
| 555 | | PŁYTKA OBWODU DUKOWANEGO C-2400-346E | | | BN-75/3311-01 | - | 1 | | 6625 | TORAL | | |
| 556 | | KOLEK KONTAKTOWY JEKROSTRONNY 04 AG | | | ZN-79/MPM-14/UNI-006 | 8832-010-215-185 | 2 | 6.00 | 6625 | UNITECH | | |
| 557 | | PODŁADKA KONDENSATORA D-1660-018-1 | | | | 8832-010-461-085 | 1 | | 6625 | UNIMOR | | |
| 558 | LI | DRUT OSM 0,5 | | | 9N-71/3051-01 | - | 2,6 | | 6625 | | | |

WZESCI MODULU PAKI MV-100? 9625-2400-1

| | | | | | | | | |
|-------|---------------------------------------|---------|---------------------|---------------------|------------------|--------|------|--------|
| U301 | UKŁAD SCALONY TDA 1170S | 00PUL | 1266 P-385,00 -ATES | WT-80/CEMI/A-42 | 1156-221-304-000 | 330.00 | N625 | ATES |
| T301 | TRANZYSTOR RD 136 | | | WT-77/CEMI/R12/A-02 | 1156-142-501-087 | 40.00 | N625 | CEMI |
| D301 | DIODA BZP 683 C 22 | | | WT-79/CEMI/A-57 | 1156-112-203-009 | 30.00 | N625 | CEMI |
| D302 | DIODA RVP 401-50 | | | PN-81/3375-29.03 | 1156-131-307-004 | 20.00 | N625 | CEMI |
| D303 | DIODA BAP 795 | | | WT-73/L7/145 | 1158-111-055-398 | 21.00 | N625 | CEMI |
| R302 | REZYSTOR RDCO 5 W | 39 OM | 5% | WT-73/L7/143 | 1158-115-011-124 | 30.00 | N625 | TELP00 |
| R302 | POTENCJOMETR TYP-114 | 100 KOM | | WT-77/L7/072 | 1158-112-640-517 | 8.00 | N625 | TELP00 |
| R303 | REZYSTOR OWZ-2A 0,25 W | 150 KOM | 5% | WT-77/L7/072 | 1158-112-640-517 | 4.00 | N625 | TELP00 |
| R304 | REZYSTOR OWZ-2A 0,25 W | 150 KOM | 5% | WT-73/L7/143 | 1158-115-011-124 | 4.00 | N625 | TELP00 |
| R305 | POTENCJOMETR TYP-114 | 100 KOM | | WT-77/L7/072 | 1158-112-640-586 | 8.00 | N625 | TELP00 |
| R306 | REZYSTOR OWZ-2A 0,25 W | 300 KOM | 5% | WT-77/L7/072 | 1158-112-640-354 | 4.00 | N625 | TELP00 |
| R307 | REZYSTOR OWZ-2A 0,25 W | 33 KOM | 5% | WT-77/L7/072 | 1158-115-011-111 | 4.00 | N625 | TELP00 |
| R308 | POTENCJOMETR TYP-114 | 47 KOM | | WT-73/L7/143 | 1158-112-640-395 | 8.00 | N625 | TELP00 |
| R309 | REZYSTOR OWZ-2A 0,25 W | 47 KOM | 5% | WT-79/L7/215 | 1158-112-817-424 | 4.00 | N625 | TELP00 |
| R310 | REZYSTOR RWC-0414-0 | 1 OM | 5% | WT-77/L7/072 | 1158-112-640-176 | 4.00 | N625 | TELP00 |
| R311 | REZYSTOR OWZ-2A 0,25 W | 5,6 KOM | 5% | WT-79/L7/215 | 1158-112-817-541 | 4.00 | N625 | TELP00 |
| R312 | REZYSTOR RWC-0414-0 | 3,3 OM | 5% | WT-77/L7/072 | 1158-112-641-368 | 2.00 | N625 | TELP00 |
| R313 | REZYSTOR OWZ-2A 0,25 W | 220 KOM | 10% | WT-77/L7/072 | 1158-112-640-339 | 4.00 | N625 | TELP00 |
| R314 | REZYSTOR OWZ-2A 0,25 W | 27 KOM | 5% | WT-77/L7/072 | 1158-112-640-000 | 4.00 | N625 | TELP00 |
| R315 | REZYSTOR OWZ-2A 0,25 W | 2,7 KOM | 5% | WT-77/L7/072 | 1158-112-639-996 | 4.00 | N625 | TELP00 |
| R316 | REZYSTOR OWZ-2A 0,25 W | 1 KOM | 5% | WT-73/L7/145 | 1158-111-055-459 | 30.00 | N625 | TELP00 |
| R317 | REZYSTOR RDCO 5 W | 68 OM | 5% | WT-77/L7/072 | 1158-112-640-135 | 4.00 | N625 | TELP00 |
| R318 | REZYSTOR OWZ-2A 0,25 W | 3,9 KOM | 5% | WT-77/L7/072 | 1158-112-638-190 | 2.00 | N625 | TELP00 |
| R319 | REZYSTOR OWZ-2A 0,125 W | 3,3 KOM | 10% | WT-68/1-MKSE-012 | 1158-127-052-905 | 23.00 | N625 | WIFLEX |
| C301 | KONDENSATOR MKSE-012 | 150NF | 5% | PN-77/3281-38 | 1158-124-625-014 | 40.00 | N625 | ELWA |
| C302 | KONDENSATOR 047U TYP 2 | 1000 UF | 25 V | ZN-81/PM-14/L15-02 | 1158-127-022-840 | 14.00 | N625 | WIFLEX |
| C303 | KONDENSATOR MKSE-20 | 100NF | 10% | WT-68/1-MKSE-012 | 1158-124-626-071 | 11.00 | N625 | WIFLEX |
| C304 | KONDENSATOR 027E TYP 2 | 100 UF | 25 V | PN-78/3281-35 | 1158-135-516-093 | 10.00 | N625 | CERAD |
| C305 | KONDENSATOR MKSE-012 | 100NF | 5% | WT-68/1-MKSE-012 | 1158-127-052-770 | 18.00 | N625 | ELWA |
| C306 | KONDENSATOR MKSE-012 | 100NF | 5% | WT-68/1-MKSE-012 | 1158-124-626-030 | 11.00 | N625 | WIFLEX |
| C307 | KONDENSATOR MKSE-20 | 100NF | 10% | WT-68/1-MKSE-012 | 1158-135-016-270 | 8.00 | N625 | CERAD |
| C308 | KONDENSATOR KCP-1R-0-33-J-160-658 | 22 UF | 25 V | WT-68/1-MKSE-012 | 1158-642-855-220 | 8.00 | N625 | ELTRA |
| C309 | KONDENSATOR 047U TYP 2 | 22 UF | 25 V | WT-68/1-MKSE-012 | 8832-010-461-085 | 8832 | N625 | TORAL |
| C311 | KONDENSATOR MKSE-20 | 22NF | 10% | WT-68/1-MKSE-012 | 8832-010-612-487 | 8832 | N625 | UNIMOR |
| C312 | KONDENSATOR KCP-2E-4-1M5-2-250-658 | 22NF | 10% | WT-68/1-MKSE-012 | | | N625 | UNIMOR |
| C312 | KONDENSATOR KCP-2E-4-1M5-2-250-658 | 22NF | 10% | WT-68/1-MKSE-012 | | | N625 | UNIMOR |
| PG301 | ZŁĄCZE MCDUJONE MG-14 | | | WT-68/1-MKSE-012 | | | N625 | UNIMOR |
| 5594 | PLATKA OPMODU DPUKOMANEGO C-2400-361F | | | WT-68/1-MKSE-012 | | | N625 | UNIMOR |
| 5595 | PODKŁADKA KONDENSATORA 0-1640-018-1 | | | WT-68/1-MKSE-012 | | | N625 | UNIMOR |
| 5596 | RADIATOR D-2160-075-1 | | | WT-68/1-MKSE-012 | | | N625 | UNIMOR |
| 5597 | | | | WT-68/1-MKSE-012 | | | N625 | UNIMOR |

| 1 | 2 | 3 | 4 | 5 | 6 | 7 | 8 | 9 | 10 | 11 | 12 | 13 |
|---|--|---|---|---|---|---|---|---|----|----|----|----|
| 598 | RADIATOR 0-2570-056-1 | | | | | | | | | | | |
| 599 | PODŁADKA STALOWA 3,2 ZN | | | | | | | | | | | |
| 600 | WKRĘT STALOWY M3X6-4,8-J ZN | | | | | | | | | | | |
| 601 | NAKRETKA STALOWA M3-6-I ZN | | | | | | | | | | | |
| 602 | PRZEWOD T0Y 1X0,50 CZARNY | | | | | | | | | | | |
| 603 | PRZEWOD T0Y 1X0,50 CZARNY | | | | | | | | | | | |
| 604 | PRZEWOD T0Y 1X0,50 CZARNY | | | | | | | | | | | |
| CZĘŚCI MODUŁU WIZJI MW-1002 I4-C-4492-006-1 | | | | | | | | | | | | |
| 605 | TRANSYSTOR RF 458 | | | | | | | | | | | |
| 606 | D351 DIODA BAVP 20 | | | | | | | | | | | |
| 607 | R351 REZYSTOR MLI 0,5 W 150 OM 5% P 435 | | | | | | | | | | | |
| 608 | R352 REZYSTOR RMW-0207-0 10 OM 10% | | | | | | | | | | | |
| 609 | R353 REZYSTOR MLI 2 W 10 KOM 5% P 435 | | | | | | | | | | | |
| 610 | R354 REZYSTOR MW-2A 1 W 2,2 KOM 10% | | | | | | | | | | | |
| 611 | R355 REZYSTOR MW-2A 0,25 W 470 KOM 10% | | | | | | | | | | | |
| 612 | R356 REZYSTOR RMW 0,25 W 15 KOM 10% | | | | | | | | | | | |
| 613 | R357 REZYSTOR RMW 0,25 W 5 KOM 10% | | | | | | | | | | | |
| 614 | R358 POTENCJOMETR PN26-AK 5 KOM LIN -10+30% | | | | | | | | | | | |
| 615 | R359 REZYSTOR RMW 0,5 W 15 KOM 10% | | | | | | | | | | | |
| 616 | R360 REZYSTOR RMW 0,5 W 15 KOM 10% | | | | | | | | | | | |
| 617 | R361 REZYSTOR RMW-0309-0 100 KOM 5% | | | | | | | | | | | |
| 618 | R362 REZYSTOR RMW-0207-0 150 OM 10% | | | | | | | | | | | |
| 619 | C351 KONDENSATOR KFP-25-A-680-K-160-658 | | | | | | | | | | | |
| 620 | C352 KONDENSATOR MKSE-018-02 680NF 20% 100V- | | | | | | | | | | | |
| 621 | C353 KONDENSATOR MKSE-018-02 100NF 20% 250V- | | | | | | | | | | | |
| 622 | C354 KONDENSATOR KFP-25-16-100 S-250-658 | | | | | | | | | | | |
| 623 | W2 NIASADKA H3-1 | | | | | | | | | | | |
| 624 | W8 NIASADKA H7-1 | | | | | | | | | | | |
| 625 | ZAPINKA UWASIAJACA T4-C-2165-036-1 | | | | | | | | | | | |
| 626 | PŁYTKA OBRÓTU DRUKOWANEGO T4-C-2217-287 | | | | | | | | | | | |
| 627 | ZŁĄCZ SPRZYNKOWE T4-E-2561-014-2 | | | | | | | | | | | |
| 628 | KOLPK KONTAKTOWY JEDNOSTRONNY 04 AG | | | | | | | | | | | |
| 629 | EKRAN PŁYTKI WIZJI T4-C-2256-082-1 | | | | | | | | | | | |
| 630 | KLIPO 3-2 T4-E-2421-615-1 | | | | | | | | | | | |
| 631 | KLIPO 10-7 T4-C-2621-616-1 | | | | | | | | | | | |
| 632 | TULEJKA PŁYTKI WIZYJNEJ T4-D-2621-617-1 | | | | | | | | | | | |
| 633 | RADIATOR T4-D-2633-010-1 | | | | | | | | | | | |
| 634 | KLIPO PŁYTKI WIZJI T4-D-2681-073-1 | | | | | | | | | | | |
| 635 | PODŁADKA STALOWA 3,2 ZN | | | | | | | | | | | |
| 636 | WKRĘT STALOWY M3X6-4,8-II ZN | | | | | | | | | | | |
| 637 | NAKRETKA STALOWA M3-6-I ZN | | | | | | | | | | | |
| 638 | DRUT OSW 1,3 | | | | | | | | | | | |
| 639 | PRZEWOD LAYC-750 1X0,75 CZARNY | | | | | | | | | | | |
| 640 | PRZEWOD TŁWY 10X0,20 | | | | | | | | | | | |

LEGENDA: KOLUMNA 6 - ILOSC SZTUK WSADU NA 1 WYR0B
KOLUMNA 7 - ILOSC SZTUK CZĘŚCI ZAM. NA 100 WYR0B0W

KOLUMNA 8 - RODZAJ OPAKOWANIA
KOLUMNA 9 - SPOS0B UMIESZCZENIA METKI
UWAGA: ILOSCI PRZEWOD0W I WĘZY Z PCW SA PODANE W CMNTYMETRACH

dotyczy:

OT NEPTUN 453A

Odbiorniki telewizyjne NEPTUN 453A różnią się od odbiorników telewizyjnych NEPTUN 453 tylko stosowanym zespołem załączająco-programującym. W odbiornikach NEPTUN 453A zastosowano zespół typu ZZP 20310 M w/g rysunku 9653-3300-3 (w OT NEPTUN 453 stosowany jest zespół ZZP 20410 M w/g rysunku 9653-3300-2 poz. Lp. 5. katalogu)

Zmianie uległy też współpracujące elementy mechaniczne, co uwidoczniono na poniższym rysunku:

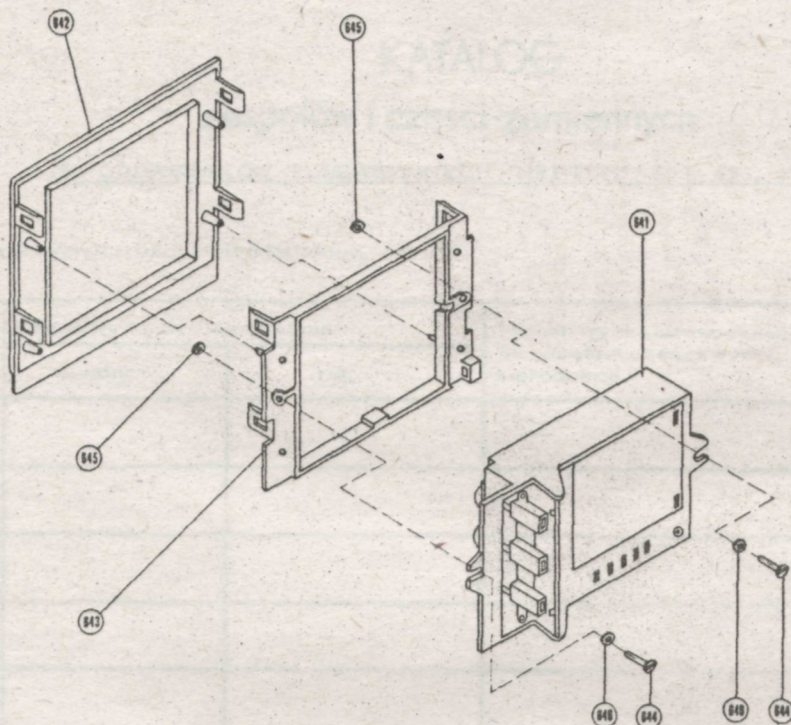

WYKAZ CZĘŚCI WYSTĘPUJĄCYCH TYLKO W OT NEPTUN 453A

| Lp. | Nazwa części, zespołu | Symbol fabryczny | Symbole KTM | Ilość szt. w wyrobie | Ilość części na 100 szt. wyrob. do l. wady | Cena detaliczna | Zastosowanie w innych wyrobach | Producent |
|-----|-------------------------------------|------------------|-------------|----------------------|--|-----------------|--------------------------------|---------------|
| 641 | Zespół załączająco-programujący | ZZP-20310 M | | 1 | | | N. 630 | ZPT Białystok |
| 642 | Płytki dekoracyjna cz. III | B-2170-171 | | 1 | 1 | | | UNIMOR |
| 643 | Płytki nośna zespołu programującego | B-2170-170 | | 1 | 1 | | | UNIMOR |
| 644 | Wkręt M3x10-48-I | PN-74/M-82227 | | 2 | | | | |
| 645 | Nakrętka M3-6-I | PN-75/M-82144 | | 2 | | | | |
| 646 | Podkładka 3,2 | PN-78/M-82007 | | 2 | | | | |

Pozostałe części i materiały zgodnie z katalogiem części zamiennych odbiorników NEPTUN 453, NEPTUN 653.

PRODUCENT

GDAŃSKIE ZAKŁADY ELEKTRONICZNE „UNIMOR” 80-822 Gdańsk, ul. Rzeźnicka 54/56

site: www.unimor.pigwa.net

scan: stryker2(at)o2.pl